

Conference Program

March, 2015

Osaka, Japan

ICBASS

International Conference on Business and
Social Sciences

ISEPST

International Symposium on Education,
Psychology, Society and Tourism

ACEAIT

Annual Conference on Engineering and
Information Technology

ISFAS

International Symposium on Fundamental and
Applied Sciences

APTPC

Asia-Pacific Teaching Professor Conference

ICBASS

International Conference on Business and Social Sciences

ISBN 978-986-89298-7-6

ISEPST

International Symposium on Education, Psychology, Society and Tourism

ISBN 978-986-89298-8-3

ACEAIT

Annual Conference on Engineering and Information Technology

ISBN 978-986-89298-6-9

ISFAS

International Symposium on Fundamental and Applied Sciences

ISBN 978-986-89298-5-2

APTPC

Asia-Pacific Teaching Professor Conference

ISBN 978-986-90263-2-1

Content

General Information for Participants	5
Conference Venue General Information	7
Conference Venue –	8
(2F Floor Plan)	8
(3F Floor Plan)	9
Conference Organization	10
ICBASS International Committee Board.....	10
ISEPST International Committee Board	11
ACEAIT International Committee Board	12
ISFAS International Committee Board.....	13
APTPC International Committee Board.....	14
Special Thanks to Session Chairs	15
Conference Schedule.....	17
Natural Science Keynote Speech	20
Social Science Keynote Speech	22
Tutorial Workshop	23
Oral Sessions –March 23	26
Marketing & Management (1)	26
Computer Engineering and Technology (1)	28
Chemical Engineering	30
Education (1).....	32
Nanotechnology & Physics Sciences	34
Electrical Engineering and Technology (1)	36
Banking & Finance (1)	37
Business & Economics (1).....	39
Geology, Earth and Environmental Sciences (1)	41
Industrial Management & Mechanical Engineering and Technology (1)	43
Education(2) & Culture.....	45
Business & Economics (2).....	47
Information Engineering and Technology (1).....	49
Computer Engineering and Technology (2)	51
Psychology.....	53
Oral Sessions –March 24	55
Marketing & Management (2)	55
Banking & Finance (2)	57
Mechanical Engineering and Technology (2)	58
Politics & Law	60

Biophysics & Biomedical Engineering	61
Business & Economics (3).....	63
Information Engineering and Technology (2).....	64
Electrical Engineering and Technology (2)	65
Education (3).....	67
Green Technology	69
Communication & Society (1).....	70
Information Engineering and Technology (3).....	72
Electrical Engineering and Technology (3)	74
Tourism	75
Marketing & Management (3)	77
Marketing & Management (4)	78
Geology, Earth and Environmental Sciences (2)	80
Food, Agriculture and Veterinary Sciences (1)	81
Communication & Society (2).....	83
Marketing & Management (5)	84
Civil Engineering & Materials Science and Engineering	85
Food, Agriculture and Veterinary Sciences (2)	87
Education (4) & Teaching	89
Poster Sessions–March 23	91
Poster Session (1).....	91
Education & Culture/ Psychology/ Business & Economics	91
Poster Session (2).....	95
Banking & Finance/ Communication & Society/ Marketing & Management/ Tourism .	95
Poster Session (2).....	98
Electrical Engineering and Technology	98
Poster Session (3).....	101
Biomedical Engineering/ Biophysics/Civil Engineering/ Chemical Sciences/	
Computer Engineering and Technology/ Information Engineering and Technology	
/ Materials Science and Engineering/ Mechanical Engineering and Technology	101
Poster Session (4).....	106
Food, Agriculture and Veterinary Sciences/ Geology, Earth and Environmental	
Sciences/ Green Technology/ Nanotechnology/ Physics Sciences	106

General Information for Participants

*** Information and Registration**

The Registration and Information Desk will be situated at the **Osaka International House Foundation** on the **2F** during the following time:

08:00-17:30 March 23, 2015

08:30-17:00 March 24, 2015

Organizer



Higher Education Forum (HEF)

Tel: + 886 2 2740 1498 | www.prohef.org



*** Presentations and Equipment**

All presentation rooms are equipped with a screen, an LCD projector, and a laptop computer installed with Microsoft PowerPoint. You will be able to insert your USB flash drive into the computer and double check your file in PowerPoint. We recommend that you bring two copies the file in case of one fails. You may also link your own laptop to the provided projector, however please ensure you have the requisite connector.

*** A Polite Request to All Participants**

Participants are requested to arrive in a timely fashion for all addresses, whether to their own, or to those of other presenters. Presenters are reminded that the time slots should be divided fairly and equally between the number of presentations, and that they should not overrun. The session chair is asked to assume this timekeeping role and summarize clarify key important issues in each topic.



Sandals or Slippers



Tank Top



Shorts

* Poster Sessions & Poster Requirements



Materials Provided by the Conference Organizer:

1. X-frame display & Base Fabric Canvases (60cm×160cm)
2. Adhesive Tapes or Clamps

Materials Prepared by the Presenters:

1. Home-made Poster(s)
2. Material: not limited, can be posted on the canvases
3. Size: 60cm*160cm

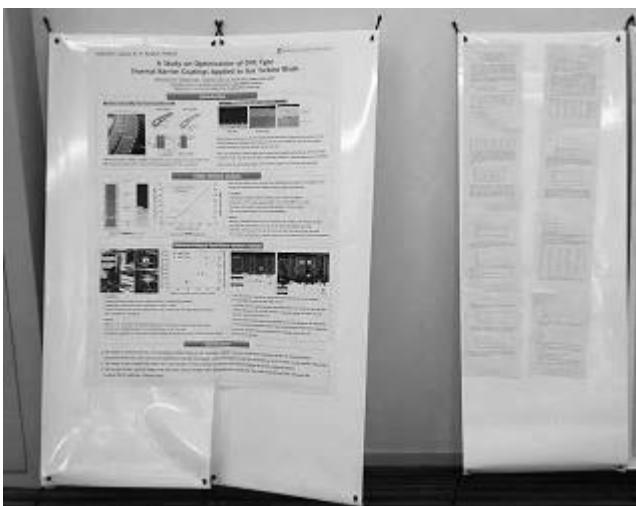
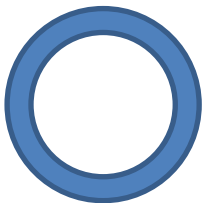

	
<p>A 60cm*160cm Poster Illustrates the research findings.</p>	<ol style="list-style-type: none"> 1.Wider than 60cm (left) 2.Copy of PowerPoint Slides in A4 papers (right)
	

Conference Venue General Information

Osaka International House Foundation

Contact Number:

Information Center Tel: 06-6773-8989 Fax: 06-6773-8421

Address: 2-6 Uehommachi 8-chome, Tennoji-ku, Osaka 543-0001 Japan

<http://www.ih-osaka.or.jp/english/>

Osaka International House Foundation is a public-service corporation founded by Osaka City with permission from the Ministry of Foreign Affairs, with the purpose of contributing to the internationalization of Japan. Based in Osaka, International House, Osaka (i-house) acts as a focal point for international exchange activities within the Kansai Region. By exploring the history, culture and other local aspects of Japan and other countries the Foundation strives to help foster a mutual understanding and friendship between citizens, and deepen relationships between Japan and other countries of the world.



Conference Venue –

Osaka International House Foundation

(2F Floor Plan)

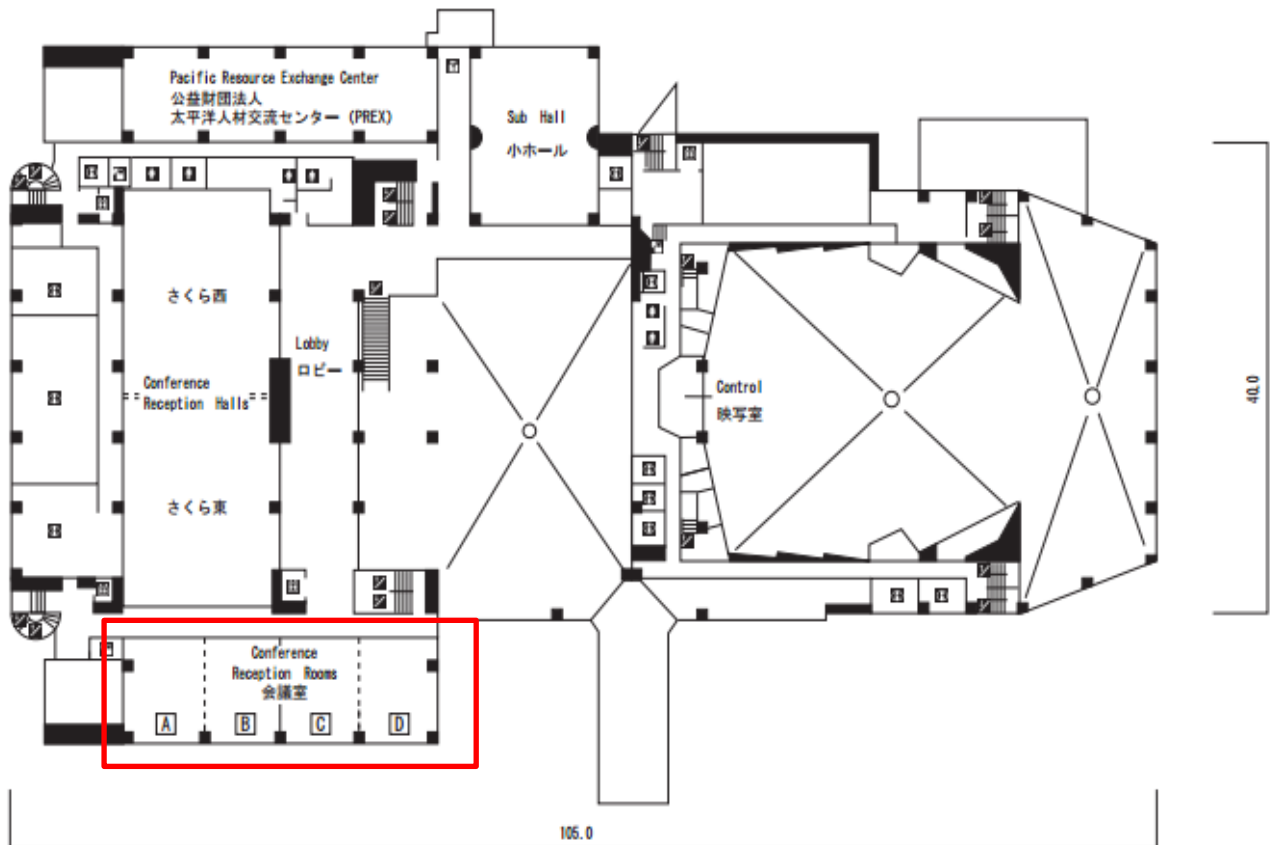

Osaka International House Foundation

(3F Floor Plan)

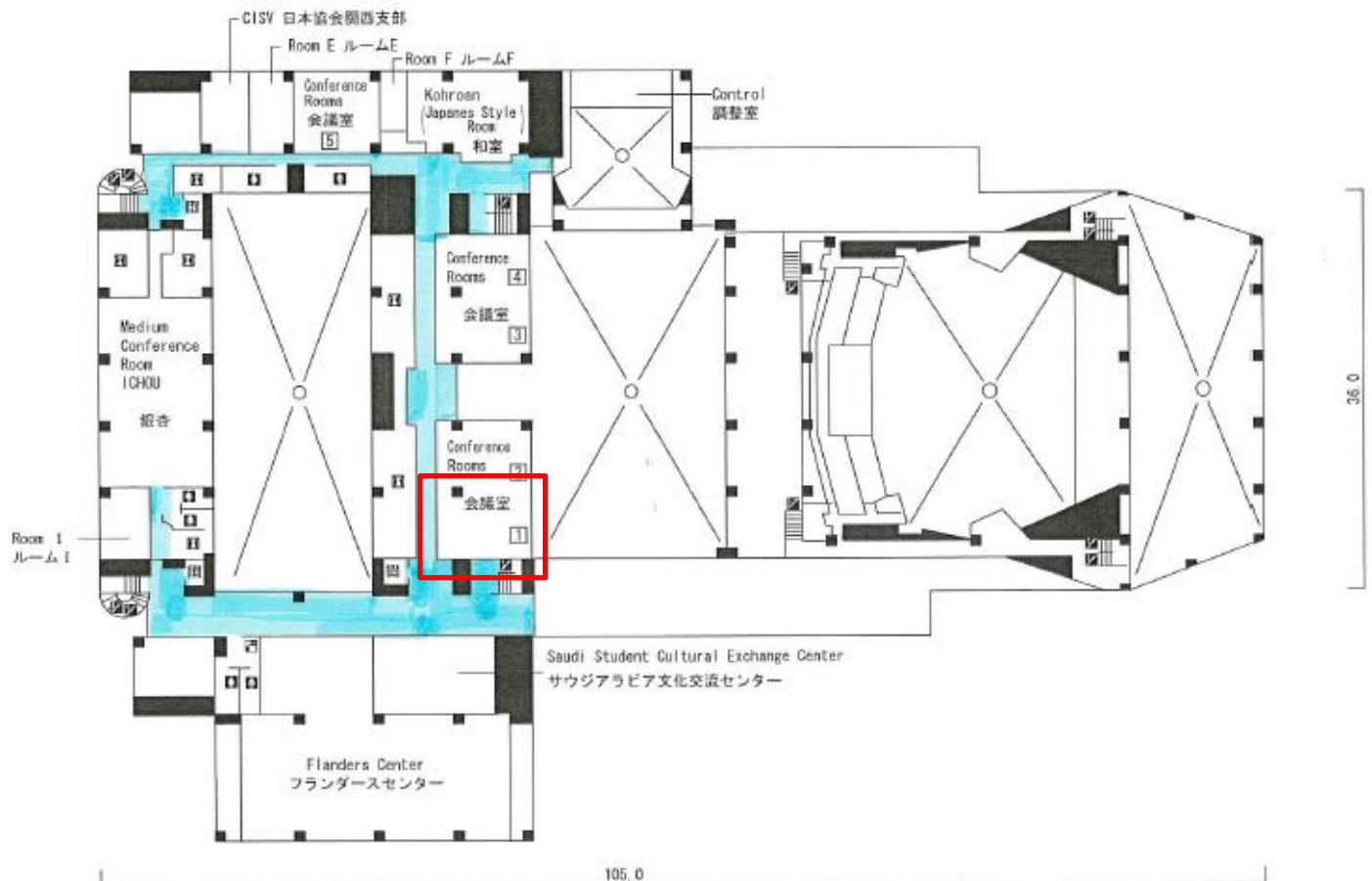

ICBASS International Committee Board

Tian Guang, Business School of Shantou University

Umar-Fahmi Achmadi, University of Australia

Engku Mohammad Nazri Engku Abu Bakar, Northern University of Malaysia

Jamilah Hj Ahmad, Universiti Sains Malaysia

Kim Tong Won, Sungkyunkwan University

Deniss Tsi Chung Yeung, Wintec

Muhammad Akram Naseem, University of Lahore

Hong Liu, Nanyang Technological University

Zhou Zhen, Ningxia University

Grace Edmar Elizardel Prado, Western Visayas College of Science and Technology

Chunhui Liu, University of Winnipeg

Saddam Hussain Rahim, Iqra national University

Weon Jae Kim, University of Incheon

Sundaram Janakiraman, SIM University

Bob Barrett, American Public University

Maria Rebecca Alviar Campos, De La Salle University

Shim Chang-Hack, Gyeongsang National University

Subhasish Dasgupta, George Washington University

Marieta Banez Sumagaysay, University of the Philippines Visayas Tacloban College

ISEPST International Committee Board

Abbas Gholtash, Islamic Azad University
Adrian North, Curtin University
Armin Mahmoudi, Academic Member University
Asrul Akmal Shafie, University of Malaya
Awam Amkpa, New York University
Bishnu Mohan Dash, University of Delhi
Cai Su, Beijing Normal University
Channaveer Rachayya Mathapati, Davangere University
Debkumar Chakrabarti, Indian Institute of Technology Guwahati
Geoffrey I. Nwaka, Abia State University
I Wayan Suyadnya, Brawijaya University
Laura B. Liu, Ed.D., Beijing Normal University's Center for Teacher Education Development
Leela Pradhan, Central Department of Education, Tribhuvan University
Lee Byung Hyuk, University of Seoul
Li-Ling Yang, Roger Williams University
Lee, Yang, Gyeongsang National University
Haskins Laboratories, Yale University
Mahabbat Pernebaevna Ospanbaeva, Taraz State Pedagogical Institute
Khalachuchi Flores, Southwestern University
Md Abdul Jalil, Shahjalal University of Science & Technology
Mohamed Azmi Ahmad Hassali, Universiti Sains Malaysia
Napaporn Srichanyachon, Language Institute, Bangkok University
Özlem AVCI, Uşak University
Rajeshwari Nagaraj Kenchappanavar, Karnatak Arts College, INDIA
Reyhan Bilgiç, Middle East Technical University
Rizwana Yousaf, University of Gujrat
Robert Evola, Université de Yaoundé
Sakina Riaz, University of Karachi, PAKISTAN
Subhan El Hafiz, Muhammadiyah University
Tirelo Modie-Moroka, University of Botswana
Ying Xing, China University of Political Science and Law
Young-Ok Kim, Chonnam National University

ACEAIT International Committee Board

Subhananda Chakrabarti, Indian Institute of Technology Bombay

Maryam Jalalifarahani, Islamic Azad University

Sunyang Chung, Konkuk University

Ravi Saxena, Nirma University

Mahadev Haridas Gavhane, SRTMU Nanded UGC

Abbas Madandar Arani, Lorestan University

Dharam Vir Mahajan, N. A. S. Post-graduate College

Jagpreet Kaur, Punjabi University

Ilango Ponnuswami, Bharathidasan University

Aijaz Ali Wassan, University of Sindh

Raj Kumar Yadav, St. Xaviers College

Rajan Mathew, University of Swaziland

Kamlesh Mahajan, Ismail National Girls Post-graduate College

Cesar Correa Arias, University of Guadalajara

Habibollah Abolhassan Shirazi, Tehran Azad University

Fu Wai Chee Ada, The Chinese University of Hong Kong

Mukti Kanta Mohanty, Autonomous College

Raju Pandurangji Lipte, Nagpur University

Asadullah Naghdi, Bu-ali sina university

Eduardo Erazo Acosta, University of Nariño

Mu-Song Chen, Da-Yeh University

Ir. Dr. Hj. Ramli Nazir, Universiti Teknologi Malaysia

Adel Hejaaji, Engineering Services Management Limited

ISFAS International Committee Board

Khalid M. Mosalam, University of California
Chueerat Jaruskulchai, Kasetsart University
M. Cheralathan, SRM University
J N Bandyopadhyay, Indian Institute of Technology Kharagpur
S. Dhar, University of Calcutta
Poongothai Shankar, Annamalai University
Amit Agrawal, Indian Institute of Technology Bombay
Cheng Li, The Hong Kong Polytechnic University
T.M. Indra Mahlia, University of Malaya
Kunal Ghosh, Indian Institute of Technology Kanpur
Narayanan Kulathuramaiyer, University of Sarawak Malaysia
Arup K. Sarma, Indian Institute of Technology Guwahati
Suresh K Bhargava, School of Applied Sciences
Rapeepan Pitakaso, Ubonratchthani University
Jie Liu, Carleton University
Carlos Alejandro Figueroa, Plasmar Tecnologia
Dong-Ho Ha, Konkuk University
Poul Vaeggemose, VIA University College Denmark
Maha M. O. Khayyat, Umm Al-Qura University
Kant Kanyarusoke, Cape Peninsula University of Technology
Paramita Bhattacharjee, Jadavpur University
Nathalia Devina Widjaja, Binus International University
C. M. Khalique, North-West University, South Africa

APTPC International Committee Board

Khalid M. Mosalam, University of California
Chueerat Jaruskulchai, Kasetsart University
M. Cheralathan, SRM University
J N Bandyopadhyay, Indian Institute of Technology Kharagpur
S. Dhar, University of Calcutta
Poongothai Shankar, Annamalai University
Amit Agrawal, Indian Institute of Technology Bombay
Cheng Li, The Hong Kong Polytechnic University
T.M. Indra Mahlia, University of Malaya
Kunal Ghosh, Indian Institute of Technology Kanpur
Narayanan Kulathuramaiyer, University of Sarawak Malaysia
Arup K. Sarma, Indian Institute of Technology Guwahati
Suresh K Bhargava, School of Applied Sciences
Banerji P, Indian Institute of Technology Kharagpur
P.K. Ghosh, Indian Institute of Technology Poorkee
E George Dharma Prakash Raj, Bharathidasan University
R.P.Bhatnagar, Birla Institute of Technology
V. Vijayagopal, Annamalai University
Amit Awekar, Indian Institute of Technology Guwahati
Pui-In Mak, University of Macau
E,Rathakrishnan, Indian Institute of Technology Kanpur
Bassim H. Hameed, University of Science Malaysia
Sudhirkumar Barai, Indian Institute of Technology Kharagpur
S. N. Sarkar, Calcutta University

Special Thanks to Session Chairs

Keith Hideo Sakuda	<i>University of Hawaii West Oahu</i>
Chomtip Pornpanomchai	<i>Mahidol University</i>
Hyoung Jin Choi	<i>Inha University</i>
San Fan Ng	<i>Macao Polytechnic Institute</i>
Chantaraporn Phalakornkule	<i>King Mongkut ' s University of Technology Thonburi</i>
Ansgar Kern	<i>Technische Hochschule Mittelhessen</i>
Mingshan Zhang	<i>University of California – Los Angeles</i>
Boonthawan Wingwon	<i>Lampang Rajabhat University</i>
Kanita Thanacharoenchanaphasa	<i>Naresuan University</i>
Pensiri Tongpadungrod	<i>Prince of Songkla University</i>
Ching-Chih Kuo	<i>National Taiwan Normal University</i>
Joonil Kim	<i>Korea University</i>
Saad Mohamed Darwish	<i>University of Alexandria</i>
Shi-Jinn Horng	<i>National Taiwan University of Science and Technology</i>
Tomoko Adachi	<i>Osaka Kyoiku University</i>
Hwee Ling Lim	<i>The Petroleum Institute</i>
<i>Liping Sui</i>	<i>Dongbei University of Finance & Economics</i>
Lih-Wu Hourng	<i>National Central University</i>
David Charles Donald	<i>The Chinese University of Hong Kong</i>
Zhiguang Xu	<i>Valdosta State University</i>
Jittima Tongurai	<i>Miyazaki International College</i>
Paulus Insap Santosa	<i>Universitas Gadjah Mada</i>
Worapong Tangsrirat	<i>King Mongkut ' s Institute of Technology Ladkrabang</i>
Jutamas Chotibang	<i>Chiangmai University</i>
Jiang-Jen Lin	<i>National Taiwan University</i>
Amanda M. Y. Chu	<i>City University of Hong Kong</i>

Ming-Chien Hung	<i>Nanhua University</i>
Wandee Petchmaneelumka	<i>King Mongkut ' s Institute of Technology Ladkrabang</i>
Wu-Chung Wu	<i>National Kaohsiung University of Hospitality and Tourism</i>
Zheng Liu	<i>Xian Jiaotong-Liverpool University</i>
Yi-Ning Tu	<i>Fu Jen Catholic University</i>
Joon Hyub Kim	<i>Joon Hyub Kim / Korea University</i>
Rahmi Rahmi	<i>University of Tadulako</i>
Obydullah Al Marjuk	<i>Independent University, Bangladesh</i>
Chia Chen Chen	<i>National Chung Hsing University</i>
Minhaz Uddin Ahmed	<i>Universiti Brunei Darussalam</i>
Semuel-Leunufna	<i>Pattimura University</i>
Raymond Francis	<i>Central Michigan University</i>

Conference Schedule

Sunday, March 22
Committee Meeting (Executive Committee Only)

Monday, March 23		
Oral Sessions Osaka International House Foundation, 2F		
Time	Schedule	Venue
08:00-17:30	Registration	2F
08:45-10:45	Marketing & Management (1)	Room A, 2F
	Computer Engineering and Technology (1)	Room B, 2F
	Chemical Engineering	Room C, 2F
	Education (1)	Room D, 2F
10:45-11:00	Tea Break	
11:00-12:00	Natural Science Keynote Speech–Hj Ramli Nazir “Applications of Hybrid-Artificial Neural Network in Geotechnical Engineering”	Room A, 2F
	Social Science Keynote Speech– Adriana E. Edwards Wurzinger “Riding the Burnout Wave (even further!): A Sociological Approach to Understanding and Tackling Burnout”	Room D, 2F
12:00-13:00	Lunch Time	
13:00-14:30	Tutorial Workshop Speech– Adriana E. Edwards Wurzinger- "Getting to the Core: Reconsidering Identity and its Layers to Promote Creativity "	Room A, 2F
	Nanotechnology & Physics Sciences	Room B, 2F
	Electrical Engineering and Technology (1)	Room C, 2F
	Banking & Finance (1)	Room D, 2F
14:30-14:45	Tea Break	

Monday, March 23		
Oral Sessions Osaka International House Foundation, 2F		
Time	Schedule	Venue
14:45-16:15	Business & Economics (1)	Room A, 2F
	Geology, Earth and Environmental Sciences (1)	Room B, 2F
	Industrial Management & Mechanical Engineering and Technology (1)	Room C, 2F
	Education (2) & Culture	Room D, 2F
16:15-16:30	Tea Break	
16:30-18:00	Business & Economics (2)	Room A, 2F
	Information Engineering and Technology (1)	Room B, 2F
	Computer Engineering and Technology (2)	Room C, 2F
	Psychology	Room D, 2F

Monday, March 23		
Poster Sessions Osaka International House Foundation Room 1, 3F		
Time	Schedule	Venue
10:00-11:00	Education & Culture/ Psychology/ Business & Economics	Room 1, 3F
13:30-14:30	Banking & Finance/ Communication & Society/ Marketing & Management/ Tourism	
	Electrical Engineering and Technology	
15:00-16:00	Biomedical Engineering/ Biophysics/ Civil Engineering/Chemical Sciences/ Computer Engineering and Technology/ Information Engineering and Technology/ Materials Science and Engineering/ Mechanical Engineering and Technology	
16:30-17:30	Food, Agriculture and Veterinary Sciences/ Geology, Earth and Environmental Sciences/ Green Technology/ Nanotechnology/ Physics Sciences	

Tuesday, March 24		
Oral Sessions		
Osaka International House Foundation		
Time	Schedule	Venue
08:30-17:00	Registration	2F
08:45-10:15	Marketing & Management (2)	Room A, 2F
	Banking & Finance (2)	Room B, 2F
	Mechanical Engineering and Technology (2)	Room C, 2F
	Politics & Law	Room D, 2F
	Biophysics & Biomedical Engineering	Room 1, 3F
10:15-10:30	Tea Break	
10:30-12:00	Business & Economics (3)	Room A, 2F
	Information Engineering and Technology (2)	Room B, 2F
	Electrical Engineering and Technology (2)	Room C, 2F
	Education (3)	Room D, 2F
	Green Technology	Room 1, 3F
12:00-13:00	Lunch Time	
13:00-14:30	Communication & Society (1)	Room A, 2F
	Information Engineering and Technology (3)	Room B, 2F
	Electrical Engineering and Technology (3)	Room C, 2F
	Tourism	Room D, 2F
	Marketing & Management (3)	Room 1, 3F
14:30-14:45	Tea Break	
14:45-16:15	Marketing & Management (4)	Room A, 2F
	Geology, Earth and Environmental Sciences (2)	Room B, 2F
	Food, Agriculture and Veterinary Sciences (1)	Room C, 2F
	Communication & Society (2)	Room D, 2F
16:15-16:30	Tea Break	
16:30-18:00	Marketing & Management (5)	Room A, 2F
	Civil Engineering & Materials Science and Engineering	Room B, 2F
	Food, Agriculture and Veterinary Sciences (2)	Room C, 2F
	Education (4) & Teaching	Room D, 2F

Natural Science Keynote Speech

Room A, 2F

11:00-12:00

Monday, March 23

Topic: “Applications of Hybrid-Artificial Neural Network in Geotechnical Engineering”

Ramli Nazir, PhD, P. Eng (Mal),

Professor of Geotechnical Engineering

Faculty of Civil Engineering, Universiti Teknologi Malaysia



Abstract

Geotechnical engineers face many uncertainties in relation with their design works. This is due to the non-homogeneity of the soil materials that they are dealing with. Recently several studies have proved that feasibility of artificial neural network (ANN) in solving different geotechnical problems. It is well established that ANN as a function approximation tool that tries to find a nonlinear relationships between parameters can be implemented for estimating several soil properties, including the compression index, shear strength, permeability, soil compaction, lateral earth pressure, and others. However, over the last few years, some researchers addressed ANN deficiency in finding global minima and slow rate of learning. Alternatively, to improve the ANN prediction power, they suggested the use of hybrid ANN which combines global search algorithms such as particle swarm optimization (PSO) and genetic algorithm (GA) with conventional ANN. The main objective of this paper is to provide a general view of hybrid ANN application in geotechnical engineering. The paper is not intended to provide details of ANN modelling procedure, but rather, for brevity purpose, it tries to cover a number of hybrid-ANN application in predicting the bearing capacity and settlement of both deep and shallow foundations. The paper suggest the prediction performance of hybrid-ANN is better than that of conventional ANN. It recommends the hybrid ANN implementation, as a more reliable, economic and quick tool, in solving geotechnical problems more specifically when the contact nature between parameters is unknown and complex. Results base from the author's works indicate that the pile bearing capacities predicted by GA-based ANN are in close agreement with measured bearing capacities. Coefficient of determination as well as mean square error equal to 0.990 and 0.002 for testing datasets respectively. The model performance using PSO-based ANN model also

shows a close agreement between the measured bearing capacities for shallow foundation based on the coefficient of determination value. The determination values equal to 0.997 and 0.991 for training and testing datasets respectively. While using a Back Propagation techniques shows that ANN is a powerful and accurate tool in predicting the bearing capacity of spread foundations. The coefficient of determination equals to 0.99 suggests that the predicted bearing capacity by ANN model is in close agreement to the measured bearing capacity. The results conclude that the Hybrid ANN model serves as a reliable and simple predictive tool to appropriately consider various essential parameters for predicting the bearing capacity of either shallow or deep foundations.

(Keywords: Artificial Neural Network, bearing capacity, shallow foundation, deep foundation, hybrid.)

Social Science Keynote Speech

Room D, 2F

11:00-12:00

Monday, March 23

Topic:

" Riding the Burnout Wave (even further!): A Sociological Approach to Understanding and Tackling Burnout "

Associate Professor

Adriana E. Edwards Wurzinger

Affiliation: Saitama University,

Center for English Education & Development (CEED)

Japan, Saitama Prefecture, Saitama City



Outline:

In response to the very positive feedback and questions received from attendees and colleagues, I will be taking up the issue of "burnout" once again, and try to further our discussion to reach new depths together.

Nobody is completely free from the effects of stress. No news there.

There is nothing wrong with the exhilarating feeling of being challenged, with the adrenaline that a limited amount of stress (the kind you can keep under control) can bring to our professional lives, but how much is enough? Where is the thin line between positive, creativity-fostering stress, and simple, straightforward burnout?

During this presentation, we will uncover and discuss the elements of burnout using sociological principles, aiming at creating a scaffolding of strategies that would allow the participants to put together their very own "survival kit".

Be prepared to participate! This will be the kind of talk where you'll have to walk the walk!



Riding the Burnout Wave (even further)

**A Sociological Approach to Understanding
and Tackling Burnout**

Adriana E. Edwards Wurzinger

Center for English Education & Development
Saitama University
Japan

Tutorial Workshop

Room A, 2F

13:00-14:30

Monday, March 23

Topic: "Getting to the Core: Reconsidering Identity and its Layers to Promote Creativity"

Associate Professor

Adriana E. Edwards Wurzinger

Affiliation: Saitama University,

Center for English Education & Development (CEED)

Japan, Saitama Prefecture, Saitama City



We normally understand our Identity as our anchor, our stronghold, our firm answer in times of doubt and struggle. What if, just for a few minutes, just for today, we could fully engage in a challenging exercise that would rattle our Identity “cages” and open up a very different view?

This tutorial session will take us on a journey towards a better, more comprehensive and honest look at how our individual and collective sense of Identity operates. We will build our answers together, explore our questions and issues, identify the reasons why we do not feel comfortable with change (and why we should or shouldn’t!), and put together the pieces of a puzzle that is as exciting as it is terrifying: a real Sense of You.



GETTING TO THE CORE

Reconsidering Identity
& its Multiple Layers
to Promote Creativity

Adriana E. Edwards Wurzinger
Center for English Education & Development
Saitama University
Japan

Oral Sessions –March 23

Marketing & Management (1)

Room A, 2F

2015/3/23 Monday 08:45-10:45

Session Chair: *Keith Hideo Sakuda*

ICBASS-7370

A Study of Key Determinants for Low-Cost Carriers in Taiwan

Tina Wan-Yun Cheng | *National Kaohsiung First University of Science and Technology*

I-Ching Lin | *National Kaohsiung First University of Science and Technology*

Ta-Hui Yang | *National Kaohsiung First University of Science and Technology*

ICBASS-7383

The Expatriate Assignment and Work Performance: A Field Study of Professional Athletes

Keith Hideo Sakuda | *University of Hawaii West Oahu*

ICBASS-7508

Knowledge Transfer Performance of MNCs: Exploring the Roles of Functional Diversification and Orientation

Sirisuhk Rakthin | *College of Management Mahidol University*

ICBASS-7341

A VIKOR Method for Evaluating the Performance of Tourist Hotels in Taiwan

Tsung-Han Chang | *Kao-Yuan University*

Pei-Jung Yang | *Kao-Yuan University*

ICBASS-7314

Impact of Internal Strategic Marketing, Job Satisfaction and Organizational Commitment toward Employee Performance of Thai Private Hospitals

Janthila Srikrajang | *Lampang Rajabhat University*

Thanakorn Noithonglek | *Lampang Rajabhat University*

Piyakanit Chotwanich | *Lampang Rajabhat University*

ICBASS-7315**Correlations between Business Strategy and Innovation Management toward the Business Operation of SME's Entrepreneurs Muang District, Lampang Province of Thailand**

Napawan Netpradit | *Lampang Rajabhat University*

Mayuree Phromthep | *Lampang Rajabhat University*

Bostong, U. | *Lampang Rajabhat University*

Banlang, S. | *Lampang Rajabhat University*

Wattapanich, P. | *Lampang Rajabhat University*

ICBASS-7412**The Mediation Roles of Cross-Cultural Dynamic Competences and Adjustment for the Influence of Work-Role Demands on Expatriation Effectiveness**

Li-Yueh Lee | *Kun Shan University*

Alfiyatul Qomariyah | *Chinese Culture University*

ICBASS-7415**The Outcomes of Customers' Brand Experiential Values**

Wann-Yih Wu | *Nanhua University*

Nadia Anridho | *Chinese Culture University*

Ying-Kai Liao | *Nanhua University*

ICBASS-7431**Ambush Marketing and Olympic Symbols Association Right Protection: With Special Reference to London Olympics 2012**

Yachi Chiang | *National Taipei University of Technology*

Computer Engineering and Technology (1)

Room B, 2F

2015/3/23 Monday 08:45-10:45

Session Chair: *Chomtip Pornpanomchai*

ACEAIT-3650

Postage Stamp Recognition System Using Artificial Neural Networks

Chomtip Pornpanomchai | *Mahidol University*

Pimprapai Leerasakultham | *Mahidol University*

ACEAIT-3704

Creating Photographic Mosaic Using Limited Tile Images

Liang-Ting Lee | *Yuan Ze University*

Ran-Zan Wang | *Yuan Ze University*

ACEAIT-3716

Applying Classification Technique to Explore the Learning Effectiveness of Different Learning Styles of Students in a HTML Certification Exam System

Gwo-Haur Hwang | *Ling Tung University*

I-Hui Li | *Ling Tung University*

Hen-Lin Huang | *Ling Tung University*

ACEAIT-3723

The Conceptual Frame Work: Development of Medical Information and Data Exchange Referral System in Thailand

Teerin Ketvichit | *Sripatum University*

Surasak Mungsing | *Sripatum University*

ACEAIT-3746

Scheduling Algorithm Based on Delay Threshold in LTE Downlink System

Po-Hsueh Wang | *National Chung-Hsing University*

Shang-Juh Kao | *National Chung-Hsing University*

Fu-Ming Chang | *Chaoyung University of Technology*

ACEAIT-3750**Low Latency OpenFlow Applications for Dynamic Policy Based on DIFANE**

Chih-Kuan Yen | *National Chung-Hsing University*

Shang-Juh Kao | *National Chung-Hsing University*

ACEAIT-3795**Securing AODV Routing Protocol in Mobile Ad Hoc Network Using Artificial Immune System**

Maha Abdelhaq | *University Kebangsaan Malaysia*

Raed Alsaqour | *University Kebangsaan Malaysia*

Shawkat Abdelhaq | *Indiana Wesleyan University*

ACEAIT-3810**Elastic Cluster Computing**

Henry Tufo | *University of Colorado at Boulder*

Chemical Engineering

Room C, 2F

2015/3/23 Monday 08:45-10:45

Session Chair: *Hyoung Jin Choi*

ACEAIT-3657

CO₂ Capture Using Fly Ash and Bottom Ash as Solid Sorbent and Their Post Capture Applications

Mahinsasa Rathnayake | *Sirindhorn International Institute of Technology, Thammasat University*

Pumiwat Vacharapong | *Sirindhorn International Institute of Technology, Thammasat University*

Somnuk Tangtermsirikul | *Sirindhorn International Institute of Technology, Thammasat University*

Pisanu Toochinda | *Sirindhorn International Institute of Technology, Thammasat University*

ACEAIT-3668

Molecular Dynamics Simulations of Mycobacterium Tuberculosis Dihydrofolate Reductase in Complex with Dihydrofolate and Pyrimethamine

Pimonluck Sittikornpaiboon | *Sirindhorn International Institute of Technology, Thammasat University*

Luckhana Lawtrakul | *Sirindhorn International Institute of Technology, Thammasat University*

ISFAS-1201

Soft-Magnetic Microspheres and Their Magnetorheology

Hyoung Jin Choi | *Inha University*

ISFAS-1223

Utilizing Bio-Extract of Coconut Juice, Ginger with Coconut Juice and Lemongrass with Coconut Juice as a Latex Coagulant

Saisamorn Lumlong | *Ubon Ratchathani University*

Naphawan Komonrit | *Ubon Ratchathani University*

Dieter Baurecht | *University of Vienna*

Peter Wolschann | *University of Vienna*

ISFAS-1251

Antioxidant Activities and Chemical Constituents from Leaves of *Dodonaea Vcosa*

Nipawan Pongprom | *Ubon Ratchathani University*

Nawara Samritsakulchai | *Ubon Ratchathani University*

Sirima Naksongkeaw | *Ubon Ratchathani University*

Nutida Singjam | *Ubon Ratchathani University*

Amornrat Chalee | *Ubon Ratchathani University*

Norman Mangnall | *Ubon Ratchathani University*

Stefan Kohlbacher | *Ubon Ratchathani University*

ISFAS-1312

Degradation of Fluoranthene and Pyrene with *Burkholderia Fungorum* sp. Using Two Medium Plates

Raden Darmawan | *Kumamoto University*

Haruhiko Nakata | *Kumamoto University*

Hiroto Ohta | *Kumamoto University*

Takuro Niidome | *Kumamoto University*

Shigeru Morimura | *Kumamoto University*

Kiyoshi Takikawa | *Kumamoto University*

Education (1)

Room D, 2F

2015/3/23 Monday 08:45-10:45

Session Chair: *San Fan Ng*

ISEPST-512

A Study on Attitudes towards Physical Education Course for College Students

San Fan Ng | *Macao Polytechnic Institute*

ISEPST-523

An Investigation of Relationship between Types of Problem-Solving and Mathematical Literacy

Wen-Chun Tai | *National University of Tainan*

Su-Wei Lin | *National University of Tainan*

ISEPST-539

Latent Class Analysis of Students' Mathematics Learning Strategy and the Relationship between Strategy and Mathematical Literacy

Su-Wei Lin | *National University of Tainan*

Wen-ChunTai | *National University of Tainan*

ISEPST-571

Assessing Effectiveness of a Multi-Representation Nanotechnology Teaching Module on Secondary School Students' Learning

Shu-Ching Wang | *National Changhua University of Education*

Kuo Hua Wang | *National Changhua University of Education*

ISEPST-592

Socio-Political Approach to Exploring How to Become an Inquiry-Based Mathematics Teacher

Li-Ching You | *National University of Tainan*

APTPC-112**Influence Factors of Tertiary Students' Entrepreneurship Career Self-Making: Using Internship Cognition as the Mediator Variable**

Chun-Mei Chou | *National Yunlin University of Science and Technology*

Chien-Hua Shen | *Transworld Institute of Technology*

His-Chi Hsiao | *Cheng Shin University*

Su-Chang Chen | *National Penghu University of Science and Technology*

Hui-Tzu Chang | *National Chiao Tung University*

Jing-Yi Chen | *Department of Information Management National Yunlin University of Science and Technology*

ISEPST-530**Exploring the Cultural Features of an Aboriginal Elementary School in New Taipei City**

Wu Hui-Hua | *National Dong Hwa University*

ICBASS-7293**Factors Slackening the “Education Quality” in the Schools of Nepal**

Binod Bhattarai | *Tokyo University of Foreign Studies*

Nanotechnology & Physics Sciences

Room B, 2F

2015/3/23 Monday 13:00-14:30

Session Chair: *Jiang-Jen Lin*

ISFAS-1214

Synthesis of Novel Rheology Modifying Agents for Dispersing Phosphorescent Phosphor Powder in Epoxy Encapsulation of LED Light

Yu-Ting Tsai | *National Taiwan University*

Shih-Huang Tung | *National Taiwan University*

Jiang-Jen Lin | *National Taiwan University*

ISFAS-1216

Synthesis of Novel Polymeric Sol-Gel Agents for Promoting Epoxy/Clay Nanocomposites

Ya-Chen Lin | *National Taiwan University*

Chien-Yi Liao | *National Taiwan University*

Jiang-Jen Lin | *National Taiwan University*

ISFAS-1247

Sensitive and Simultaneous Detection of Zn (II), Cd (II), and Pb (II) Using Graphene-Polyaniline Nanocomposite Modified Electrode

Nipapan Ruecha | *Chulalongkorn University*

Nadnudda Rodthongkum | *Chulalongkorn University*

David Cate | *Colorado State University*

John Volckens | *Colorado State University*

Orawon Chailapakul | *Chulalongkorn University*

Charles Sherman Henry | *Colorado State University*

ISFAS-1317

Visible-Light-Induced Photodegradation Performance of Multi-Morphological Nb-Doped Titanium Dioxide Nanomaterials

Wei-Cheng Chen | *Chang Gung University*

Ting-Han Lin | *Chang Gung University*

Jyun-Sian Chih | *Chang Gung University*

Ming-Chung Wu | *Chang Gung University*

ISFAS-1265

An Unbiased Optimization Approach to Study the Structural Evolution of Gold Nanoclusters

Tsung-Wen Yen | *National Central University*

S. K. Lai | *National Central University*

Electrical Engineering and Technology (1)

Room C, 2F

2015/3/23 Monday 13:00-14:30

Session Chair: *Ansgar Kern*

ACEAIT-3791

A Study of A-IGZO TFTs with Single-Gate and Dual-Gate Structures

Chih-Chieh Hsu | *National Yunlin University of Science and Technology*

Chien-Hsun Wu | *National Yunlin University of Science and Technology*

Yu-Min Hsieh | *National Yunlin University of Science and Technology*

ACEAIT-3797

Effects of Plasma Damage on Source/Drain Contact Regions of an Amorphous InGaZnO Thin Film Transistor

Chih-Chieh Hsu | *National Yunlin University of Science and Technology*

Hui-Chun Cheng | *National Yunlin University of Science and Technology*

ACEAIT-3648

Feasibility Analysis of Battery Energy Storage in Power Distribution System

Suthida Taiwal | *Sirindhorn International Institute of Technology, Thammasat University*

Chalie Charoenlarnpopparut | *Sirindhorn International Institute of Technology, Thammasat University*

ACEAIT-3708

Standardising Real Time Applications without Real Time Operating Systems

Ansgar Kern | *Technische Hochschule Mittelhessen*

Maurice Friedl | *Technische Hochschule Mittelhessen*

ACEAIT-3715

Initial Study of Rainfall Rates Distribution and Simulation of Terrestrial Microwave Links Using EUMETSAT's Multi-Sensor Precipitation Estimate in Malaysia

Hafiz Basarudin | *University Kuala Lumpur*

Aizat Faiz Ramli | *University Kuala Lumpur*

Ismail Sulaiman | *University Kuala Lumpur*

Banking & Finance (1)

Room D, 2F

2015/3/23 Monday 13:00-14:30

Session Chair: *Mingshan Zhang*

ICBASS-7389

Sports Sentiment Matters: The Relation between FIFA World Cup Match Results and Sponsors' Stock Returns

Ching-Wei Chiu | *I-Shou University*

Jen-Sin Lee | *I-Shou University*

ICBASS-7393

Information Asymmetry, Institutional Trading, and Cost of Capital

Mingshan Zhang | *Kean University*

ICBASS-7476

Closing Price Manipulation on Month-End Days and Market Transparency: Evidence from Taiwan

Yu Chuan Huang | *National Kaohsiung First University of Science and Technology*

Sheng-Min Lin | *National Kaohsiung First University of Science and Technology*

ICBASS-7480

Investigating Factors that Influence the Successful of Enterprise Resource Planning (ERP) System Using Gable et al Model Study at Mandiri Bank, Indonesia

Christiyaningsih Budiwati | *Sebelas Maret University*

Okfidsa Java W | *Sebelas Maret University*

Lulus Kurniasih | *Sebelas Maret University*

ICBASS-7541

Analysis of IPO Underpricing Fluctuation: Empirical Study in Indonesia Stock Exchange

Mamduh M Hanafi | *Universitas Gadjah Mada*

ICBASS-7491**Disappearing Dividend in Indonesia**

Leo Indra Wardhana | *Universitas Gadjah Mada*

Eduardus Tandelilin | *Universitas Gadjah Mada*

I Wayan Nuka Lantara | *Universitas Gadjah Mada*

John Eddy Junarsin | *Universitas Gadjah Mada*

ICBASS-7388**The Predictability of Carry Trade Returns and Foreign Exchange Risk: Using a Panel Smooth Transition Regression Analysis**

Mei-Se Chien | *National Kaohsiung University of Applied Sciences*

Chien-Chiang Lee | *National Sun Yat-sen University*

Yu-Wei Fan | *National Kaohsiung University of Applied Sciences*

Business & Economics (1)

Room A, 2F

2015/3/23 Monday 14:45-16:15

Session Chair: *Boonthawan Wingwon*

ICBASS-7311

The Impact of Social Capital Integrated Management and Innovation toward Sustained Competitive Advantage of the Tourism Sector in Northern Region Thailand

Boonthawan Wingwon | *Lampang Rajabhat University*

Thanakorn Noithonglek | *Lampang Rajabhat University*

Boonchanit Wingworn | *Maemoh Hospital*

ICBASS-7328

The Development of Local Wisdom Product Supply Chain, Nakaew Sub-District, Kohkha District, Lampang Province

Porjai Singhanate | *Lampang Rajabhat University*

Usa Bostong | *Lampang Rajabhat University*

Mayuree Promtep | *Lampang Rajabhat University*

ICBASS-7352

Multi-Period Efficiency Measurement with Interval-Valued Data and Weight Restrictions

Shiang-Tai Liu | *Vanung University*

ICBASS-7355

Communicating Denials of Assurance: Case of Auditors and Audit Disclaimers

Hashanah Ismail | *Universiti Putra Malaysia*

ICBASS-7360

Bicycle Sharing System Design Problem

Ta-Hui Yang | *National Kaohsiung First University of Science and Technology*

Heng-Chi Lee | *National Kaohsiung First University of Science and Technology*

Ming-Der Yang | *National Kaohsiung First University of Science and Technology*

Jenn-Rong Lin | *National Taiwan Ocean University*

Ya-Chi Yen | *National Kaohsiung First University of Science and Technology*

ICBASS-7557

Financial Distress of Local Governments in Indonesia

Lulus Kurniasih | *Sebelas Maret University*

Christiyaningsih Budiwa | *Sebelas Maret University*

Juliati Arifia | *Sebelas Maret University*

ICBASS-7387

Dynamic Linkage of Foreign Exchange Rate and Export Elasticity under the Trend of Regional Economic Integration

Yu-Chih Chang | *National Kaohsiung University of Applied Sciences*

Mei-Se Chien | *National Kaohsiung University of Applied Sciences*

Chien-Chiang Lee | *National Sun Yat-sen University*

Geology, Earth and Environmental Sciences (1)

Room B, 2F

2015/3/23 Monday 14:45-16:15

Session Chair: *Kanita Thanacharoenchanaphasa*

ISFAS-1205

Assesement on Diversity and Abundance of Hymenoptera at Selected Forests in Pulau Langkawi, Malaysia

Siti Khairiyah Mohd Hatta | *Universiti Teknologi MARA*

Saiyid Jalaluddin | *Universiti Teknologi MARA*

Wan Seribani | *Universiti Teknologi MARA*

Norashirene Mohamad Jamil | *Universiti Teknologi MARA*

Asmida Ismail | *Universiti Teknologi MARA*

ISFAS-1253

Climate Change and Its Impact on Sensitive Crop: A Case Study of Simulation of Temperature-Humidity Changes in Growing Season and Its Impacts on Thai Soybean Fatty Acids Content

Kanita Thanacharoenchanaphasa | *Naresuan University*

Orose Rugchati | *Naresuan University*

ISFAS-1283

Rural Water Supply System in Thailand – A Comprehensive Study of Resource, Quality, Health Risk, and Engineering Aspects

Sudjit Karuchit | *Suranaree University of Technology*

Jareeya Yimrattanabovorn | *Suranaree University of Technology*

Preeyaphorn Kosa | *Suranaree University of Technology*

Prapat Pentamwa | *Suranaree University of Technology*

Patcharin Racho | *Suranaree University of Technology*

ISFAS-1306

Utilising Quadrat Method for Biodiversity Study of Seaweeds in Blue Lagoon, Port Dickson, Malaysia

Asmida Ismail | *Universiti Teknologi MARA*

Siti Khairiyah Mohd Hatta | *Universiti Teknologi MARA*

Norashirene Mohd Jamil | *Universiti Teknologi MARA*

Dzulsuhaimi Daud | *Universiti Teknologi MARA*

Ahmad Ismail | *Universiti Kebangsaan Malaysia*

Industrial Management & Mechanical Engineering and Technology (1)

Room C, 2F

2015/3/23 Monday 14:45-16:15

Session Chair: *Pensiri Tongpadungrod*

ISFAS-1215

Using Data Envelopment Analysis to Evaluate Technical Training Program for Maintenance Units

Nai-Chieh Wei | *I-Shou University*

Tzu-Jou Liao | *I-Shou University*

Chiung-Fen Chang | *I-Shou University*

Shui-Cheung Cham | *I-Shou University*

ISFAS-1234

A Study of Investigating Jewelry Boutique Personnel Training Courses

Chiao-Ping Bao | *I-Shou University*

Nai-Chieh Wei | *I-Shou University*

Shu-Chuan Chen | *I-Shou University*

ISFAS-1314

Design of PSA Process Parameters for CH₄/CO₂ Separation

Songwut Yosantea | *King Mongkut's University of Technology North Bangkok*

Jatupol Khunpolgrang | *King Mongkut's University of Technology North Bangkok*

Chantaraporn Phalakornkule | *King Mongkut's University of Technology North Bangkok*

Aroon Kongnoo | *Prince of Songkla University*

Pensiri Tongpadungrod | *King Mongkuts University of Technology North Bangkok*

ISFAS-1204

Joints Properties of One Side Welded of Ship Materials with Variation of Angle Groove

Yustiasih Purwaningrum | *Islamic University of Indonesia*

Tri Syarifuddin | *Islamic University of Indonesia*

Isharyadi | *Islamic University of Indonesia*

Triyono | *Sebelas Maret University*

ISFAS-1211

Air-Gap Measurement for Levitated Disc of Inductive Micro-Motor

Chih-Che Lin | *National Cheng Kung University*

Nan-Chyuan Tsai | *National Cheng Kung University*

Education(2) & Culture

Room D, 2F

2015/3/23 Monday 14:45-16:15

Session Chair: *Ching-Chih Kuo*

ICBASS-7323

Information and Communication Technology Management in Primary and Secondary Schools: Case Study of Chachoengsao Educational Service Area, Thailand

Pinkanok Wongpinpech | *King Mongkut's University of Technology North Bangkok*

ICBASS-7354

The Relationship among the Word of Mouth, Brand Image and Suggestion Willingness in Taiwan's Higher Education

I-Pin Chang | *University of Kang Ning*

I-Ching Lin | *Air Force Institute of Technology*

Hsiao-Chieh Chen | *Air Force Institute of Technology*

ICBASS-7363

From Disability to Possibility - Students with Intellectual Disabilities Go to College

Chia-Yi Teng | *National Taiwan Normal University*

Ying-Chieh Liao | *National Taiwan Normal University*

Chang-Ta Chou | *National Chi Nan University*

ICBASS-7419

Employment Transition Demands for Vocational High School Students with Specific Learning Disabilities after the Implementation of International Classification of Function in Learning Disabilities in Taiwan

Ying-Chieh Liao | *National Taiwan Normal University*

Chia-Yi Teng | *National Taiwan Normal University*

Chia-Cheng Yang | *University of Taipei*

ICBASS-7487

Learning Experiences of Young Artists with ASD in a University Enrichment Program

Ching-Chih Kuo | *National Taiwan Normal University*

Christine Ie-Ting Lin | *National Taiwan Normal University*

Ching-Chen Kuang | *Yu Da University of Science and Technology*

Ling-Tsai Dai | *Taipei American School*

ICBASS-7560**The Study Students Nurse Reflective Thinking Gained from Studying Physical Examination Using Simulation**

Songsuda Muenthaisong | *Boromarajonani College of Nursing, Khon Kaen*

Panipa Thongnarong | *Boromarajonani College of Nursing, Khon Kaen*

Thitiporn Keartkangwanb | *Boromarajonani College of Nursing, Khon Kaen*

Suratsawadee Panomkaen | *Boromarajonani College of Nursing, Khon Kaen*

Saranya Pleangkatok | *Boromarajonani College of Nursing, Khon Kaen*

ICBASS-7611**The Effects of Computer-Supported Collaborative Learning on Design Education**

Chien-Wen Jerry Chen | *Ling Tung University*

Business & Economics (2)

Room A, 2F

2015/3/23 Monday 16:30-18:00

Session Chair: *Joonil Kim*

ICBASS-7316

The Conceptual Framework: Multi-Group of Integrated Marketing Communication Service Quality and Satisfaction toward Customer Retention for Elderly Care Business in Thailand

Nongluk Promptingkran | *Lampang Rajabhat University*

Boonthawan Wingwon | *Lampang Rajabhat University*

Jatuporn Sungkawan | *Southeast Bangkok College*

ICBASS-7326

The Conceptual Frame Work: Causal Factors Effecting toward the Success of SMEs e-Commerce in Thailand

Teerin Ketvichit | *Lampang Rajabhat University*

Boonthawan Wingwon | *Lampang Rajabhat University*

Boonchanit Wingworn | *Lampang Rajabhat University*

ICBASS-7481

Institution and Multinational Investment

Xinpeng Xu | *Hong Kong Polytechnic University*

Jan P. Voon | *Lingnan University*

Yan Shang | *Hong Kong Polytechnic University*

ICBASS-7391

Microeconomic Consideration of the Impact of Telecommunications Industry: Empirical Contribution to the Internet Economy

Kazuma Kobayashi | *Chuo University*

ICBASS-7405

Motivations of FDI, Knowledge Spillover and Local Firms' Productivity

Joonil Kim | *Korea University*

ICBASS-7621

An Empirical Investigation of CO2 Emissions Converge in the 50 U.S. States

DP Tang | *National Taiwan University*

Winston Long Tang | *National Taiwan University*

ICBASS-7488

Business Development and Factors Affecting Business Performance of Local Product

Manufacturers of Household Appliances:

Anurak Artitkawin | *Lampang Rajabhat University*

Mayuree Promthep | *Lampang Rajabhat University*

Kajohnsak Wongweeraaj | *Lampang Rajabhat University*

Information Engineering and Technology (1)

Room B, 2F

2015/3/23 Monday 16:30-18:00

Session Chair: *Saad Mohamed Darwish*

ACEAIT-3635

Evolving Software Assessment and Certification Models Using Ant Colony Optimization Algorithm

Saad Mohamed Darwish | *University of Alexandria*

ACEAIT-3673

Building a Cloud Based Mission Assignment System for Container Transportation Company

Chih-Yu Jian | *Takming University of Science and Technology*

Chang-Hong Shih | *Takming University of Science and Technology*

Po-Kai Chen | *Takming University of Science and Technology*

Po-Hao Chen | *Takming University of Science and Technology*

Li-Wei Cheng | *Takming University of Science and Technology*

Wei-Sheng Wang | *Takming University of Science and Technology*

ACEAIT-3699

An Effective Authentication Scheme with Anonymity for Wireless Communications

Ya-Fen Chang | *National Taichung University of Science and Technology*

Pei-Yu Lin | *Yuan Ze University*

Yung-Chi Chen | *National Taichung University of Science and Technology*

Chi-Shiang Chan | *Asia University*

Jian-Wei Fan | *National Taichung University of Science and Technology*

Chao-Wen Chan | *National Taichung University of Science and Technology*

ACEAIT-3700

Comments on an IOT Notion-Based Authentication and Key Agreement Scheme for Heterogeneous Ad Hoc Wireless Sensor Networks

Ya-Fen Chang | *National Taichung University of Science and Technology*

Jen-Ho Yang | *Kainan University*

Wei-Han Li | *National Taichung University of Science and Technology*

Wei-Liang Tai | *Chinese Culture University*

ACEAIT-3710

Multi-Path Visible Light Communication Channel Model in Plane Cockpit

Piyaphat Phukphan | *Sirindhorn International Institute of Technology*

Chalie Charoenlarnopparut | *Sirindhorn International Institute of Technology*

Computer Engineering and Technology (2)

Room C, 2F

2015/3/23 Monday 16:30-18:00

Session Chair: *Shi-Jinn Horng*

ACEAIT-3753

OpenFlow Pipeline Processing: Applications and Modeling

Chi-Sheng Su | *National Chung-Hsing University*

Shang-Juh Kao | *National Chung-Hsing University*

ACEAIT-3762

A Smartphone Image Sensor with Light Blinking ID-Beacon for Identity Checking System

Thanavit Anuwongpinit | *King Mongkut's Institute of Technology*

Boonchana Purahong | *King Mongkut's Institute of Technology*

Sarayut Tattakittiya | *King Mongkut's Institute of Technology*

Vanvisa Chutchavong | *King Mongkut's Institute of Technology*

ACEAIT-3784

Gesture Recognition Applications in Embedded Systems

Shi-Jinn Horng | *National Taiwan University of Science and Technology*

Yan-Ting Li | *National Taiwan University of Science and Technology*

Tianrui Li | *Southwest Jiaotong University*

ACEAIT-3792

System Development for Size Estimation of Cooked Shrimp Using Image Processing

Apinai Rerkratn | *King Mongkut's Institute of Technology Ladkrabang*

Anucha Kaewpoonsuk | *Naresuan University*

ACEAIT-3804

On-Board Diagnostics Geocasting with Direction Assistance in VANETs

Sheng-Wei Fang | *National Chung-Hsing University*

Shang-Juh Kao | *National Chung-Hsing University*

Hsiu-Lang Wang | *National Chung Hsing University*

ACEAIT-3818

Improve Accuracy in sFlow by Dynamic Strategy with OpenFlow

Shang-Juh Kao | *National Chung Hsing University*

Kuan-Hwa Tseng | *National Chung Hsing University*

Psychology

Room D, 2F

2015/3/23 Monday 16:30-18:00

Session Chair: *Tomoko Adachi*

ICBASS-7348

Drinking Pattern and Job Performance of Operational Staff in Industrial Workplaces

Sayamon Akakulanan | *Kasetsart University*

Areekul Puangsuwan | *The University of Western Australia*

Saitib Lautongmeesakun | *King Mongkut's University of Technology North Bangkok*

Surasak Chaiyasong | *Maharakam University*

ICBASS-7356

Psychological Mechanisms behind Occupational Gender Segregation in Japan

Tomoko Adachi | *Osaka Kyoiku University*

ICBASS-7510

The Life Beyond School – Support Parents of the Students with Intellectual Disabilities to Explore which Steps to Take after Their Children's Graduation from High School

Cheng-Ta Chou | *National Chi-Nan University*

Chia-Yi Teng | *National Taiwan Normal University*

ISEPST-555

Pragmatic Oddities Pertaining to Autism Spectrum Disorders: A Revelation of Executive Dysfunction

Yan Grace Lam | *Hong Kong Institute of Education*

ISEPST-566

Theory of Mind, Gender, Age and Social Economic Status: A Theoretical Model of Symbolic and Imaginary Play

Dewi Retno Suminar | *Airlangga University*

Thomas Dicky Hastjarjo | *Gajah Mada University*

MG Adiyanti | *Gajah Mada University*

ISEPST-525

**Professional Socialization, Professional Identity and Intention to Be Successful Engineer
of Students in Faculty of Engineer at Bangkok, Thailand**

Pinkanok Wongpinpech | *King Mongkuts University of Technology North Bangkok*

Oral Sessions –March 24

Marketing & Management (2)

Room A, 2F

2015/3/24 Tuesday 08:45-10:15

Session Chair: *Hwee Ling Lim*

ICBASS-7442

Changing Employment Relations Practices in Hong Kong: Cases of Two Multinational Retail Banks since 1997

Teresa Shuk-Ching Poon | *Open University of Hong Kong*

ICBASS-7337

UAE Generation Y Learning Preferences for Technical Skills: Degree of Fit with Actual Knowledge Transfer Practices at Work

Hwee Ling Lim | *The Petroleum Institute*

ICBASS-7312

The Liability of Renewal: The Impact of Changes in Organizational Capability, Performance, Legitimacy and Pressure for Change

Sultan Mohammed Alshehri | *Kwansei Gakuin University*

ICBASS-7366

Not Only Employees Affect Customers, But Customers Also Affect Employees. Exploring the Relationship among Customer Emotion, Employee Emotion, and Emotional Labor

Yu-Chi Wu | *National University of Kaohsiung*

Hong-De Sie | *National University of Kaohsiung*

ICBASS-7372

The Effects of Work Engagement on Customer Delight : The Role of Emotional Labor

Yi-Chin Wang | *National University of Kaohsiung*

Yu-Chi Wu | *National University of Kaohsiung*

ICBASS-7496

Assessing Performance of Customer-Oriented Product Returns Service

Chonlada Sajjanit | *Thammasat University*

Nopadol Rompho | *Thammasat University*

Banking & Finance (2)

Room B, 2F

2015/3/24 Tuesday 08:45-10:15

Session Chair: *Liping Sui*

ICBASS-7568

Financial Crime Data Analytics

Keith Barrett Carter | *National University of Singapore*

ICBASS-7582

International Oil Price Uncertainty, Credit Resource Acquisition and Corporation Investment: Empirical Evidence from Chinese Capital Market

Yong Wang | *China University of Petroleum*

Erwei Xiang | *Murdoch University*

ICBASS-7368

Disparity Analysis on Efficiency Evaluation and Environmental Effects of China's Regional Financial Innovation

Liping Sui | *Dongbei University of Finance and Economics*

ICBASS-7477

The Effect of Mispricing on Investment

Ruey-Shii Chen | *Tatung University*

Ming-Ren Ku | *Tatung University*

Wan-Wen Huang | *Tatung University*

Mechanical Engineering and Technology (2)

Room C, 2F

2015/3/24 Tuesday 08:45-10:15

Session Chair: *Lih-Wu Hourng*

ACEAIT-3654

The New Propeller Design 3 Blades Type on 18o Skew Angle and Testing Cavitation of Tailing Thai Boat

Jaruphant Noosomton | *King Mongkuts Institute of Technology Ladkrabang*

Jarruwat Charoensuk | *King Mongkuts Institute of Technology Ladkrabang*

ACEAIT-3665

Study on Vibration Isolation Design of Dual Piezoelectric Cooling Jets

Guang-Min Luo | *National Kaohsiung Marine University*

Shiang-Yi Wu | *National Kaohsiung Marine University*

ACEAIT-3676

The Influences of Electrolyte on the Electrochemical Machining in Silicon Wafer

Lih-Wu Hourng | *National Central University*

Hau-Wen Chang | *National Central University*

Zhi-Wen Fen | *Metal Industries Research and Development Centre*

Chin-Wei Liu | *Metal Industries Research and Development Centre*

ACEAIT-3705

Four-Wheel-Drive Electrical Vehicle Traction Control with Fuzzy Sliding Mode Controller

Shiuh-Jer Huang | *National Taiwan University of Science and Technology*

Tung-Kai Chang | *National Taiwan University of Science and Technology*

ACEAIT-3776

Correlation to Predict Optimum Meandering Turn Number of Vertical Closed-Loop Pulsating Heat Pipes

Niti Kammuang-Lue | *Chiang Mai University*

Chansin Sriwiset | *Chiang Mai University*

Phrut Sakulchangsatjatai | *Chiang Mai University*

Pradit Terdtoon | *Chiang Mai University*

ACEAIT-3745

A Low-Cost of Foot Plantar Shoes for Gait Monitoring System

Zulkifli Bin Ahmad | *Universiti Malaysia Pahang*

Mohd Razlan Azizan | *Universiti Malaysia Pahang*

Idris Mat Sahat | *Universiti Malaysia Pahang*

Zakri Ghazalli | *Universiti Malaysia Pahang*

Politics & Law

Room D, 2F

2015/3/24 Tuesday 08:45-10:15

Session Chair: *David Charles Donald*

ICBASS-7274

Enhancing ASEAN Steps on Migrant Worker Rights Protection

Patricia Audrey Ruslijanto | *Universitas Brawijaya*

Ika Ningtyas | *Universitas Brawijaya*

ICBASS-7303

Reforming Personal Property Security Law

Ji Lian Yap | *University of Hong Kong*

ICBASS-7310

Law in Regression? Impacts of Quantitative Research on Law and Regulation

David Charles Donald | *The Chinese University of Hong Kong*

ICBASS-7404

Strengthening EU Diplomacy: Realize the Potentials of the European External Action Service

Wei Ying Chen | *National Chung Hsing University*

Biophysics & Biomedical Engineering

Room 1, 3F

2015/3/24 Tuesday 08:45-10:15

Session Chair: Zhiguang Xu

ACEAIT-3687

Restenosis Effect of Bifurcational Angles in the Left Coronary Artery by Fluid-Structure Interaction

Guan-Heng Jhong | *National Cheng Kung University*

Chih-Wei Wang | *National Cheng Kung University*

Shih-Hsuan Shen | *I-Shou University*

Po-Chum Wong | *I-Shou University*

Zong-Jhe He | *I-Shou University*

Chih-Han Chang | *National Cheng Kung University*

Pao-Hsin Liu | *I-Shou University*

ACEAIT-3690

Reconstruction of Mandibular Symphysis Defect with and Without Fibular Flap by Three-Dimensional Finite Element Analysis

Chun-Hao Hung | *I-Shou University*

Jehn-Shyun Huang | *National Cheng Kung University*

Chih-Lin Wu | *I-Shou University*

Jia-Ning Tsai | *I-Shou University*

Cheng-Yun Tsai | *I-Shou University*

Pao-Hsin Liu | *I-Shou University*

ACEAIT-3691

Effect of Screw Number and Distribution in Total Temporomandibular Joint Reconstruction by Finite Element Analysis

Ting-Hui Huang | *I-Shou University*

Tzu-Hsuan Liu | *I-Shou University*

Guan-Lin Liu | *I-Shou University*

U-Hun Lo | *I-Shou University*

Ya-Yu Hsueh | *I-Shou University*

Pao-Hsin Liu | *I-Shou University*

ACEAIT-3692**Finite Element Analysis of Three Types of Mandibular Osteotomy Sections in Orthognatic Surgery**

Bang-Sia Chen | *I-Shou University*

Ting-Wei Wu | *I-Shou University*

Kai-Lin Wang | *I-Shou University*

Te-Hsin Yu | *I-Shou University*

Ya-Wen Chuang | *I-Shou University*

Pao-Hsin Liu | *I-Shou University*

ISFAS-1203**Classification of Bird Sounds Improved by a Parallelized Flocking Algorithm**

Zhiguang Xu | *Valdosta State University*

Business & Economics (3)

Room A, 2F

2015/3/24 Tuesday 10:30-12:00

Session Chair: *Jittima Tongurai*

ICBASS-7418

Network Dynamics in Inter-firm's Cooperative and Competitive Relations: A Triadic Perspective of Social Network Analysis

Kuen-Shiou Yang | *Asia University*

ICBASS-7466

An Estimated DSGE Open-Economy Model of the Indian Economy with Financial Frictions

Bo Yang | *Xian Jiaotong-Liverpool University*

ICBASS-7408

Economic Profits of Growing Avocado, Lychee, and Mulberry

Chaowana Phetcharat | *Chiangmai University*

Tuangporn Janthok | *Chiangmai University*

ICBASS-7523

R&D and Innovation Activities in Emerging Market Economies: Evidence from Thai Firms

Jittima Tongurai | *Miyazaki International College*

ICBASS-7612

Key Public Governance Issues of Smart Cities: Innovations in Municipal Investments and Management

Stephen Bailey | *University of Tampere*

Ari-Veikko Anttiroiko | *University of Tampere*

Pekka Valkama | *University of Tampere*

Information Engineering and Technology (2)

Room B, 2F

2015/3/24 Tuesday 10:30-12:00

Session Chair: *Paulus Insap Santosa*

ACEAIT-3717

Exploring the Role of Agent-Oriented Software Engineering in Service-Oriented Computing

Raymond So | *The Open University of Hong Kong*

ACEAIT-3733

CDV2: A Feature Dimension-Aware Validity Index with Cluster Collision Detection

Jian-Hua Yeh | *Aletheia University*

Shen-Kai Jan | *Aletheia University*

ACEAIT-3738

Creating Websites Using MDA Framework: A Proposed Mapping

Paulus Insap Santosa | *Universitas Gadjah Mada*

ACEAIT-3806

Effectiveness of Feature Selection in Pattern-Based Web Mining

Sheng-Tang Wu | *Asia University*

Yung-Chang Lin | *Asia University*

ACEAIT-3807

Approximation of Raised Cosine Spectrum Based on Bernstein Polynomial for Equalized Paired Echo Phenomena

Virote Pirajnanchai | *King Mongkut's Institute of Technology Ladkrabang*

Jutathip Rimmai | *King Mongkut's Institute of Technology Ladkrabang*

Kanok Janchitrapongvej | *Southeast Bangkok College*

Vanvisa Chutchavong | *King Mongkut's Institute of Technology Ladkrabang*

ACEAIT-3827

Multi-Objective Programming Model for CNC Tools-Parts Clustering Based on the Theory of Group Technology

Wuttinan Nunkaew | *Srinakharinwirot University*

Busaba Phruksaphanrat | *Thammasat University*

Electrical Engineering and Technology (2)

Room C, 2F

2015/3/24 Tuesday 10:30-12:00

Session Chair: *Worapong Tangsrirat*

ACEAIT-3754

Reference Illuminant Selection Study between High Power LED and HMI Luminaries in Studio Lighting Application for CRI Calculations

Jirasak Prechaveerakul | *King Mongkut's Institute of Technology Ladkrabang*

Chow Chompoo-Inwai | *King Mongkut's Institute of Technology Ladkrabang*

ACEAIT-3755

The Improvement of a Smart Lighting Control System in Office Building Design Concept Considering The Daylight Factor Using a Microprocessor Based and LabVIEW Program

Weerawat Wanich | *King Mongkut's Institute of Technology Ladkrabang*

Chow Chompoo-Inwai | *King Mongkut's Institute of Technology Ladkrabang*

ACEAIT-3780

Simulation of Frequency-Dependent Negative Resistance (FDNR) Using Voltage Differencing Transconductance Amplifiers (VDTAs)

Sumalee Unhavanich | *King Mongkut's Institute of Technology Ladkrabang*

Pratya Mongkolwai | *King Mongkut's Institute of Technology Ladkrabang*

Worapong Tangsrirat | *King Mongkut's Institute of Technology Ladkrabang*

ACEAIT-3781

Electronically Tunable Floating Inductance Simulator with Eight MOS Transistors and One External Capacitor

Sasitaporn Theingjit | *King Mongkut's Institute of Technology Ladkrabang*

Tattaya Pukkalanun | *King Mongkut's Institute of Technology Ladkrabang*

Worapong Tangsrirat | *King Mongkut's Institute of Technology Ladkrabang*

ACEAIT-3782

VDTA-Based Floating Capacitance Multiplier with a Grounded Capacitor

Panurut Yaruan | *King Mongkut's Institute of Technology Ladkrabang*

Pratya Mongkolwai | *King Mongkut's Institute of Technology Ladkrabang*

Sumalee Unhavanich | *King Mongkut's Institute of Technology Ladkrabang*

Worapong Tangsirat | *King Mongkut's Institute of Technology Ladkrabang*

Education (3)

Room D, 2F

2015/3/24 Tuesday 10:30-12:00

Session Chair: *Jutamas Chotibang*

APTPC-116

Development of Child Development Center through Participation of Local Communities

Jutamas Chotibang | *Chiangmai University*

Somsiri Rungamornrat | *Mahidol University*

Pissamai Wattanasit | *Prince of Songkla University*

Ninlapa Jirattanawanna | *Srinakharinwirot University*

Jirawon Tanwattanakul | *Khon Kaen University*

Mana Chuaichoo | *Dap Baan Dap Muang Association*

ISEPST-584

The Practice of a Multicultural Education Project: Educators Thinking about the New Immigrants Issues in Taiwan

Yin-Cheng Zhang | *Taiwan National Dong Hwa University*

Jun-Hua Lin | *Taiwan National Dong Hwa University*

APTPC-117

Effects of Educational Program on Kindergarten Teachers' Knowledge and Skills in Caring Early Childhood

Usanee Jintrawet | *Chiangmai University*

Jutamas Chotiban | *Chiangmai University*

Somchit Kiatwattanacharoen | *Chiangmai University*

Malee Urharmnuay | *Chiangmai University*

APTPC-119**Social Capital Utilization for Promoting Learning Experiences of Early Childhood: A Case Study of an Early Childhood Development Center, Southern Thailand**

Orawan Nukaew | *Prince of Songkla University*

Sophen Chunaun | *Prince of Songkla University*

Piyanuch Jittanoon | *Prince of Songkla University*

Aporntip Buapetch | *Prince of Songkla University*

Pissamai Wattanasit | *Prince of Songkla University*

Natthaya Cherngchalard | *Prince of Songkla University*

APTPC-120**"Kru Roi Kun" the Community Treasures Enhancing the Early Childhood Education**

Juraporn Tangpukdee | *Khon Kaen University*

Jirawon Tanwattanakul | *Khon Kaen University*

Nipa Angsupakorn | *Khon Kaen University*

APTPC-131**The Relationships among Principal's Aesthetic Leadership, Teachers' Social Network and Happiness**

Cheng-Ping Chang | *National University of Tainan*

Jih-Chiang Chen | *National University of Tainan*

Hung-Chih Tsai | *Kunshan University*

ICBASS-7566**The Senses of Sight and Hearing in John Keats's Odes**

River Ya-ling Chiang | *Chinese Culture University*

Green Technology

Room 1, 3F

2015/3/24 Tuesday 10:30-12:00

Session Chair: *Chantaraporn Phalakornkule*

ISFAS-1276

Removing Barriers: Unravelling Cycling Obstacles Using Video Ethnography- A Case Study in Chiang Mai, Thailand

Zi Liang Huang | *Chiang Mai University*

ISFAS-1321

Biogas Production Potential of Field Grass in the Tropics

Sasikarn Nuchdang | *King Mongkut's University of Technology Thonburi*

Chantaraporn Phalakornkule | *King Mongkut's University of Technology Thonburi*

ISFAS-1328

High-Sensitivity Volatile Organic Compounds Sensing Chip Made by Aligned P3HT/PMMA Fibers

Shun-Hsiang Chan | *Chang Gung University*

Ming-Chung Wu | *Chang Gung University*

Wei-Fang Su | *National Taiwan University*

ISFAS-1232

Bioorganic- An Effective Biofertilizer for Green Cultivation of Moringa

Mohammed Amin Uddin Mridha | *King Saud University*

Fahad Nasser AL-Barakah | *King Saud University*

Communication & Society (1)

Room A, 2F

2015/3/24 Tuesday 13:00-14:30

Session Chair: *Amanda M. Y. Chu*

ICBASS-7513

Relationship Trust Scale in the Chinese Context (C-RTS)

Lai Cheung Wong | *The University of Hong Kong*

Amanda M. Y. Chu | *City University of Hong Kong*

Cecilia L. W. Chan | *The University of Hong Kong*

ICBASS-7308

Utilization and Reliability of Information in Social Media: Thai Journalists News Reporting

Wattanee Phoovatis | *Bangkok University*

ICBASS-7357

Stakeholders Attitude and Behavior towards PTT Group's Oil Spill Crisis Communication

Aujcharapa Wangsawang | *Chulalongkorn University*

ICBASS-7384

Co-Rumination Mediates the Relationship between Social Support and Burnout among Service Industry Workers in Mainland China and Taiwan

Milang Yuan | *Fu jen Catholic University*

ICBASS-7454

Effectiveness of Television Commercials for Telecommunications Service Providers on Thai Consumers

Waratchaluntorn Sirivoratham | *Chulalongkorn University*

ICBASS-7493

The Relationship among Facebook Usage Behavior, Loneliness, Life Satisfaction and Stress of People in Bangkok Metropolitan Region

Pratoom Rerkklang | *National Institute of Development Administration*

ICBASS-7322

The Topic of Research: The New Muhammadiyah Values for the Postmodern Moslem World

Muhammad Azhar | *Muhammadiyah University of Yogyakarta*

Information Engineering and Technology (3)

Room B, 2F

2015/3/24 Tuesday 13:00-14:30

Session Chair: *Ming-Chien Hung*

ACEAIT-3813

Community of Practice Framework in Disaster Management Using Online Collaboration System

Ebenezer Lim Uy | *De La Salle-College of Saint Benilde*

Jose Paolo Ramirez Alcantara | *De La Salle-College of Saint Benilde*

Oliver Magsaysay Liwanag | *De La Salle-College of Saint Benilde*

ACEAIT-3817

Design of the Linear Luminance-Chrominance Gain Slope Equalizer with Bernstein Polynomials

Virote Pirajnanchai | *King Mongkut's Institute of Technology Ladkrabang*

Phornphimon Janchitrapongvej | *King Mongkut's Institute of Technology Ladkrabang*

Kanok Janchitrapongvej | *Southeast Bangkok College*

Pongpan Rattanathanawan | *Southeast Bangkok College*

Vanvisa Chutchavong | *King Mongkut's Institute of Technology Ladkrabang*

ACEAIT-3820

A Pseudo Gaussian for UWB System Based on Raised Cosine Function

Wanchalerm Chanwattanapong | *King Mongkut's Institute of Technology Ladkrabang*

Sippakorn Saeiao | *King Mongkut's Institute of Technology Ladkrabang*

Kanok Janchitrapongvej | *Southeast Bangkok College*

Vanvisa Chutchavong | *King Mongkut's Institute of Technology Ladkrabang*

ACEAIT-3832

Use and Design of Ontology-Based Multi-Agent System for Multi-Site Software Development Environment

Udsanee Pakdeetrakulwong | *Curtin University*

Pornpit Wongthongtham | *Curtin University*

ACEAIT-3834

The Effects of Deconstructed Task-Technology Fit on Mobile Bookstore Usage

Ming-Chien Hung | *Nanhua University*

Ting-Chu Hsieh | *Nanhua University*

Wen-Feng Li | *Nanhua University*

Electrical Engineering and Technology (3)

Room C, 2F

2015/3/24 Tuesday 13:00-14:30

Session Chair: *Wandee Petchmaneelumka*

ACEAIT-3787

Simple Design Technique for NMOS-Based Analog Current Multiplier Realization Suitable for Low-Voltage Application

Sorapong Wachirarattanapornkul | *King Mongkut's Institute of Technology Ladkrabang*

Worapong Tangsirat | *King Mongkut's Institute of Technology Ladkrabang*

ACEAIT-3800

The Integrated Able Unity Gain Inverter Using CMOS OTA

Thanaprasroeth Phatikitanan | *King Mongkut's Institute of Technology Ladkrabang*

Jirawath Parnklang | *King Mongkut's Institute of Technology Ladkrabang*

ACEAIT-3811

Simple Capacitance-To-Duty Cycle Converter for Capacitive Sensor

Wandee Petchmaneelumka | *King Mongkut's Institute of Technology Ladkrabang*

Chattraporn Sripisut | *King Mongkut's Institute of Technology Ladkrabang*

Thepjit Cheypoca | *King Mongkut's Institute of Technology Ladkrabang*

Vanchai Riewruja | *King Mongkut's Institute of Technology Ladkrabang*

Tourism

Room D, 2F

2015/3/24 Tuesday 13:00-14:30

Session Chair: *Wu-Chung Wu*

ISEPST-532

Exploring Food Purchasing Behavior of Consumers: Psychological Contract and Corporate Social Responsibility Matter

Jun-Zhi Chiu | *National Kaohsiung University of Hospitality and Tourism*

You-Wei Lin | *National Kaohsiung University of Hospitality and Tourism*

Chao-Chen Hsieh | *Fortune University*

ISEPST-533

In the Eye of Hotel Employees: The Impact of Organization Citizenship Behavior on Corporate Social Responsibility

Jun-Zhi Chiu | *National Kaohsiung University of Hospitality and Tourism*

Ya-Ping Huang | *National Kaohsiung University of Hospitality and Tourism*

Chao-Chen Hsieh | *Fortune University*

ISEPST-541

The Research on Relationships among Internal Marketing Strategies, Job Satisfaction and Organizational Commitment - For International Tourist Hotels in Taiwan

Wu-Chung Wu | *National Kaohsiung University of Hospitality and Tourism*

Yi-Wen Chang | *National Kaohsiung University of Hospitality and Tourism*

ISEPST-549

Research on Spatial Distribution of Literature and History in Qoli

Shao-Chi Chien | *Aletheia University*

Ting-Ting Wang | *Aletheia University*

ISEPST-552

What Should Be Known to Conduct in The Travel Industry? Extending to Knowledge-Based View

Kuan-Yang Chen | *Lunghwa University of Science and Technology*

ISEPST-550

Study on the Spatial Distribution of Plant in Ksunu Tribe

Shao-Chi Chien | *Aletheia University*

Mei-Syuan Li | *Aletheia University*

Marketing & Management (3)

Room 1, 3F

2015/3/24 Tuesday 13:00-14:30

Session Chair: *Zheng Liu*

ICBASS-7361

Religiosity and Purchase Intention for Halal Labeled Non-Food Products: Case of Malaysian Gen Y's

Hifza Rahimah Ibrahim | *Universiti Putra Malaysia*

Raja Nerina Raja Yusof | *Universiti Putra Malaysia*

Suhaimi Ab Rahman | *Universiti Putra Malaysia*

ICBASS-7484

The Conceptual Frame Work: The Effect of Tutor Characteristic as the Mediating Role between Competitive Advantage Strategy and Business Performance of Tutorial Business in Thailand

Sirimad Ratchakhom | *Lampang Rajabhat University*

Boonthawan Wingwon | *Lampang Rajabhat University*

Anusorn Kunanusorn | *University of Phayao*

ICBASS-7577

Cross-Culture Management in the Animation Industry: A Case Study of a Collaboration Project between China and Japan

Zheng Liu | *Xian Jiaotong-Liverpool University*

ICBASS-7617

Stakeholder Considerations and Timeliness of Action by Managers in the Military

Melvin Hagan | *University of Phoenix, Okinawa Campus*

Fiona Sussan | *University of Phoenix, USA*

Ravi Chinta | *University of Phoenix, USA*

Marketing & Management (4)

Room A, 2F

2015/3/24 Tuesday 14:45-16:15

Session Chair: *Yi-Ning Tu*

ICBASS-7531

Mining Your Value on the Job Market

Yi-Ning Tu | *Fu Jen Catholic University*

Jhih-Syuan Chen | *Fu Jen Catholic University*

Syue-Jing Jheng | *Fu Jen Catholic University*

Yan-Ju Chen | *Fu Jen Catholic University*

Yi-Ru Sie | *Fu Jen Catholic University*

Wan-Xin Chen | *Fu Jen Catholic University*

Wei-Hsiang Peng | *Fu Jen Catholic University*

ICBASS-7532

A Space Syntax Analysis of the Influential Spatial Features to Tenant Placement in Large-Scale Shopping Centers

Yu-Cheng Lin | *National Taipei University*

Qiao-Fan Huang | *National Taipei University*

Shun-Te Yuo | *National Taipei University*

ICBASS-7569

Research on the Relationships among Brand Image, Customer Perception, and Customer Loyalty: From the Aspects of Lottery Store a in Tainan, Taiwan

Yi-Rou Liao | *National University of Tainan*

Che-Hung Liu | *National University of Tainan*

Ya-Wen Tsai | *National University of Tainan*

ICBASS-7570

A Feasibility Study for Developing the Tainan Orchid Industry Based on the Diamond Model and Symbol Consumption

Yi Ting Ho | *National University of Tainan*

Yen-Tzu Chen | *National University of Tainan*

Pei-Yu Chiang | *National University of Tainan*

ICBASS-7321

Succession of Social Capital in Chinese Family Businesses

Jenny Oliveros Lao Phillips | *University of Saint Joseph*

Geology, Earth and Environmental Sciences (2)

Room B, 2F

2015/3/24 Tuesday 14:45-16:15

Session Chair: *Joon Hyub Kim*

ISFAS-1208

Analysis of Landslide Utilizing ASTER Satellite Images

Koung-Hoon Nam | *Andong National University*

Hak-Yun Lee | *Andong National University*

Chang-Oh Choo | *Andong National University*

Gyo-Cheol Jeong | *Andong National University*

ISFAS-1351

Evaluation of Natural Adsorbents for Removal of Fluoride from Groundwater: A Case Study from Mehsana District, Gujarat, India

Pankaj Kumar | *United Nations University*

Srikantha Herath | *United Nations University*

Hiral Patel | *Institute of Science and Technology for Advance Studies and Research*

Ram Avtar | *United Nations University*

Chander Kumar Singh | *TERI University*

ACEAIT-3732

Fast and Low-Cost Detection of Silver Nanoparticles by Using the Ag⁺-Specific Cytosine Probe

Joon Hyub Kim | *Korea University*

Ki Bum Kim | *Korea University*

Nam Ki Min | *Korea University*

ISFAS-1282

Climate Change and Its Impact on Sensitive Crop : A Case Study of Simulation of Temperature-Humidity Changes in Growing Season and Its Impacts on Essential Fatty Acids Content of Thai Soybean SJ. 5 Cultivar

Orose Rugchati | *Naresuan University*

Kanita Thanacharoenchanaphasa | *Naresuan University*

Food, Agriculture and Veterinary Sciences (1)

Room C, 2F

2015/3/24 Tuesday 14:45-16:15

Session Chair: *Rahmi Rahmi*

ISFAS-1347

Effect of Thermal Stress on Lactate Dehydrogenase Activity and Histopathological Changes in Male Red Hybrid Tilapia *Oreochromis* sp.

Hazza Roshada Ramli | *University Malaysia Terengganu*

Nazurah Harun | *University Malaysia Terengganu*

Laith A Razzak | *University Malaysia Terengganu*

Farizan Abdullah | *University Malaysia Terengganu*

Ahmad Shuhaimi Draman | *University Malaysia Terengganu*

Najiah Musa | *University Malaysia Terengganu*

Nadirah Musa | *University Malaysia Terengganu*

ISFAS-1278

Test Resistance Isolates of *Azotobacter* sp. Bioremediation of Polluted Ground as Mercury (Hg)

Rahmi Rahmi | *University of Tadulako*

Baharuddin Baharuddin | *University of Hasanuddin*

ISFAS-1336

Potatoes Cultivation on the Effect by Growth Regulator and Organic Fertilizer in Medium Plain

Rosanna Asri | *University of Muhammadiyah Makassar*

Muslimin Mustafa | *Hasanuddin University*

Baharuddin | *Hasanuddin University*

Enny Lisan | *Hasanuddin University*

ISFAS-1236

The Interaction between Endophytic Actinomycetes and Rhizobium

Asmiaty Sahur | *Hasnuddin University*

Mu'minah | *Hasnuddin University*

ISFAS-1360

Induction of Polyploidy in *Jatropha Curcas* L by Treatment with Mitotic Inhibitors

Duangporn - Premjet | *Naresuan University*

Siripong - Premjet | *Naresuan University*

ISFAS-1290

The Effects of Clone Types (Sulawesi-1, Sulawesi-2 And Local 88) and Fermentation Time Towards Fermentation Index, Fat, Total Acid, Amino Acid, and Reduction Sugar of Cocoa Beans (*Theobroma Cacao* L.)

Siti Sabahan Murtala | *Indonesian Muslim University*

Communication & Society (2)

Room D, 2F

2015/3/24 Tuesday 14:45-16:15

Session Chair: *Obydullah Al Marjuk*

ICBASS-7553

The Influence of Wai Sha Feng Shui Factors on the Housing Price and House Buyers

Chih-Peng Chang | *National Taipei University*

Chiou-Mien Lin | *National Taipei University*

ICBASS-7572

Families in Dhaka City: A Case Study in the Context of Changing Technology and Globalization

Obydullah Al Marjuk | *Independent University, Bangladesh*

Fahmida Hossain | *Asian University of Bangladesh*

ICBASS-7594

The Research of Cloud Service Acceptance—A Case Study from the Directorate General of Highways in Taiwan's Government

Wei-Hsiang Chiu | *National University of Tainan*

Che-Hung Liu | *National University of Tainan*

Hsin-Chi Tseng | *National University of Tainan*

ISEPST-519

Linkage between Frontline Employees' Service Competences and Customer Word-of-Mouth: The Moderating Role of Customer Service Experiences

Yu-Chi Wu | *National University of Kaohsiung*

Joanna Pin-Ru Liao | *National University of Kaohsiung*

ISEPST-520

The Effects of Fit between Service Types and Advertising Appeals on Service Preference - The Role of Need for Cognition

Yu-Chi Wu | *National University of Kaohsiung*

Sunny Chu Wang | *National University of Kaohsiung*

Marketing & Management (5)

Room A, 2F

2015/3/24 Tuesday 16:30-18:00

Session Chair: *Chia Chen Chen*

ICBASS-7407

Determinants of the Users Intention of Social-Local-Mobile Applications

Chia Chen Chen | *National Chung Hsing University*

Mu Yen Chen | *National Taichung University of Science and Technology*

Ruey Shun Chen | *China University of Technology*

ICBASS-7433

A Study of Green Human Resources Management (GHRM) in Hong Kong

Loretta Leung | *The Open University of Hong Kong*

Lenis Cheung | *The Open University of Hong Kong*

Alex Mak | *The Open University of Hong Kong*

Amy Mak | *The Open University of Hong Kong*

ICBASS-7379

Understanding Mother's Decisions on Baby Milk Powder Purchase: A Case of Enfa SMART+ Brand in the Thai Market

Amanda Bunga Gracia | *Chulalongkorn University*

ICBASS-7437

Japanese Consumer Cooperative: An Alternative Institutional Model to Develop Consumer Cooperatives in Thailand

Pornprapa Kikuchi | *Faculty of Economics, Kasetsart University*

Masahiro Yamao | *Graduate School of Biosphere Science, Hiroshima University*

ICBASS-7615

Utilization of Key Performance Indicators and Balanced Scorecard for Resource Management in Higher Education Institutions

Stefani Lily Indarto | *Soegijapranata Catholic University*

Theresia Dwi Hastuti | *Soegijapranata Catholic University*

Civil Engineering & Materials Science and Engineering

Room B, 2F

2015/3/24 Tuesday 16:30-18:00

Session Chair: *Minhaz Uddin Ahmed*

ACEAIT-3702

Comparing Depth Integrating Sampling and Point Integrating Sampling of Suspended Sediment Measurement at Transversal Direction of Uniform Flow in Open Channel

Fransiska Yustiana Yustiana | *Institut Teknologi Nasional*

ACEAIT-3662

Determination of Dumping Area Based on Engineering Geological Study

Twin H. W. Kristyanto | *Padjadjaran University*

Dicky Muslim | *Padjadjaran University*

Zufialdi Zakaria | *Padjadjaran University*

Joaquina I. Mendes | *Padjadjaran University*

Febri Hirnawan | *Islamic University of Bandung*

ACEAIT-3698

Acoustic Diagnostic Benchmark for Evaluating the Deterioration of Exterior Wall Tiles on Buildings

Chih-Yuan Chang | *Feng Chia University*

Ruei-Jyuan Ye | *Feng Chia University*

ISFAS-1285

Study Characteristics and Performance of Gasohol as Alternative Fuel by Partially Substitution of Gasoline with Ethanol

Bardi Murachman | *Gadjah Mada University*

Eddie Sandjaya Putra | *Gadjah Mada University*

Dicky Pranantyo | *Gadjah Mada University*

ACEAIT-3678**A Flexible and Low-Cost Polypropylene Pouch for Naked-Eye Detection of Herpes Simplex Viruses**

Minhaz Uddin Ahmed | *Universiti Brunei Darussalam*

Sharifun Nahar | *Université du Québec*

Mohammadali Safavieh | *Université du Québec*

Mohammed Zourob | *Cranfield University*

ACEAIT-3778**Flexural Behavior of Segmental Steel H-beam Prestressed with Normal Strength Steel Plate**

Mark Gil delos Santos | *Kongju National University*

Edward Gapatan | *Kongju National University*

Kim Kee Dong | *Kongju National University*

Food, Agriculture and Veterinary Sciences (2)

Room C, 2F

2015/3/24 Tuesday 16:30-18:00

Session Chair: *Semuel-Leunufna*

ISFAS-1225

Evaluation of Entomopathogenic Fungi *Metarhizium Anisopliae* against the Red Palm Weevil, *Rhynchophorus Ferrugineus* (Coleoptera: Curculionidae)

Wahizatul Afzan Azmi | *Universiti Malaysia Terengganu*

Insyirah Ishak | *Universiti Malaysia Terengganu*

Grace Ern Lin Lee | *Universiti Malaysia Terengganu*

Jamilah Mohd. Salim @ Halim | *Universiti Malaysia Terengganu*

ISFAS-1259

A Simulation Study of the Spread of Mealybugs in a Cassava Field with a Biological Control

Chontita Rattanakul | *Mahidol University*

ISFAS-1295

Kaffir Lime Leaves Extract Inhibits Biofilm Formation by *Streptococcus Mutans* in Vitro

Kanchana Usuwanthim | *Naresuan University*

Nateelak Kooltheat | *Naresuan University*

Natthapon Samakchan | *Naresuan University*

Methinee Anthapanya | *Naresuan University*

Ludthawun Kamuthachad | *Naresuan University*

ISFAS-1307

Research and Development of Yams (*Dioscorea* Spp.) as a Component of Diversification in Maluku Islands: Achievements and Challenges

Semuel-Leunufna | *Pattimura University*

Henry-Kesaulya | *Hasanuddin University*

Anthony-Walsen | *Gajah Mada University*

ISFAS-1326

**Growth and Production Response of Soybean (*Glycine Max L*) toward Granting
Mikoriza Arbuskular Fungi of Availability in Different Level Water**

Nirwana Tahir | *Indonesian Moeslim University*

ISFAS-1233

**Symbiotic Nitrogen Fixation in Alfalfa (*Medicago Sativa L.*) by *Sinorhizobium meliloti*
at Hail Regions, Saudi Arabia**

Fahad Nasser AL-Barakah | *King Saud University*

Mohammed Amin Uddin Mridha | *King Saud University*

Education (4) & Teaching

Room D, 2F

2015/3/24 Tuesday 16:30-18:00

Session Chair: *Raymond Francis*

APTPC-122

Potential and the Availability of Child Development Centers in the Management of Early Childhood Learning in the Context of Eastern Thailand

Ninlapa Jirarattanawanna | *Srinakharinwirot University*

APTPC-123

The Participant of Parents to Promote Learning of Early Childhood, Thailand Context

Sukon Vattanaamorn | *Srinakharinwirot University*

APTPC-138

Teaching English as an International Language in EFL Context: The Case of ULIS – Vietnam

Trang Thi Thu Doan | *University of Languages and International Studies*

Dieu Thi Hong Nguyen | *University of Languages and International Studies*

APTPC-108

Demonstrating Student Learning through Global Field Experiences

Raymond Francis | *Central Michigan University*

APTPC-155

Three Types of Culturally Responsive Teaching and Curriculum: Justice-Centered Education in Pursuit

Chuen-Min Jasmin Huang | *National Taiwan Normal University*

ISEPST-596

I Learn What I Need: Needs Analysis of English Learning in Taiwan

I-Ju Chen | *Ling Tung University*

Yung-Hao Chang | *Ling Tung University*

Wen-Jing Jiang | *Ling Tung University*

Hao-Wen Sung | *Ling Tung University*

Wei-Huan Chang | *Ling Tung University*

APTPC-132

**Effectiveness of Collaborative Approach in Catalyzing the Science Performance of the
Alternative Learning System Studens in Don Bosco, Manila**

Louise Elaine Faustino Caranto | *The National Teachers College*

Poster Sessions–March 23

Poster Session (1)

Education & Culture/ Psychology/ Business & Economics

Room 1, 3F

2015/3/23 Monday 10:00-11:00

ISEPST-507

A Mentor Teacher's Experiences of Using the Reflective Teaching Approach for Facilitating Teachers' Dialogues at One Professional Learning Community

Ling-Chien Kung | *Stella Maris High School*

Mei-Ying Chien | *National Dong Hwa University*

ISEPST-516

The Morphological Processing of Mandarin among Deaf Signers

Yi Shiuan Chiu | *Fu Jen Catholic University*

ISEPST-517

The Study of Integrating Nano Technology into Current Junior High School Science Curricula

Mei-Yu Chang | *National Hsinchu University of Education*

Su-Jung Lu | *Miaoli County Haikou Elementary School*

Meng-Kao Yeh | *National Tsing Hua University*

ISEPST-524

Attitude and Achievement for K-12 Students Visited a Nanotechnology Hands-on Works Exhibition

Mei-Yu Chang | *National Hsinchu University of Education*

Chiao-Ting Hsiao | *National Hsinchu University of Education*

Meng-Kao Yeh | *National Tsing Hua University*

ISEPST-528**Learning Attitude and Achievement for K-8 Students in a Summer Nanotechnology Camp**

Hung-Yin Tsai | *National Tsing Hua University*

Meng-Kao Yeh | *National Tsing Hua University*

Chiao-Ting Hsiao | *National Hsinchu University of Education*

Mei-Yu Chang | *National Hsinchu University of Education*

ISEPST-537**A Longitudinal Study of Relationships among Students' Mathematical Goal Orientations, Learning Strategies and Achievements**

Chang-Sheng Wang | *National University of Tainan*

Su-Wei Lin | *National University of Tainan*

ISEPST-538**The Relationships among Students' Mathematics Self-Efficacy, Motivation, Learning Strategies, and Literacy**

Tsung-Han Kuo | *National University of Tainan*

Su-Wei Lin | *National University of Tainan*

ISEPST-542**The Validity and Reliability Analysis of the Academic Help-Seeking Behavior Scale for Taiwanese Junior High School Students**

Pei-Chi Wang | *National Cheng Kung University*

Shu-Ling Peng | *National Cheng Kung University*

ISEPST-546**The Impact of Success/Failure Conditions on the Before-Test Emotions of Action/State-Oriented Subjects**

Hanju Chang | *National Cheng Kung University*

Shu-Ling Peng | *National Cheng Kung University*

Chungfan Hu | *National Cheng Kung University*

ISEPST-575**Innovation in the Educational Leadership-The View of Constructivism**

Hui-Ling Tang | *National Dong Hwa University*

Ying-Chun Chen | *National Dong Hwa University*

Chi-Win Fan | *National Dong Hwa University*

ISEPST-577**Discussion of Civilian in National Defense Education Policy-Formulate Regulations and Planning Policies**

Ying-Chun Chen | *National Dong Hwa University*

Hui-Ling Tang | *National Dong Hwa University*

Hui-Hua Chen | *National Dong Hwa University*

ISEPST-602**Forces and Interactions: Stability of Gold Nanoparticles**

Chi-Feng Li | *National Changhua University of Education*

Pei-Yun You | *National Changhua University of Education*

Ying-Chiao Lin | *National Changhua University of Education*

Tsai-Ling, Hsu | *National Changhua University of Education*

Pi-Yun Cheng | *National Changhua University of Education*

Yu-Hsuan Wu | *National Changhua University of Education*

Chi-Shun Tseng | *National Changhua University of Education*

Sheng-Wen Chen | *National Changhua University of Education*

Yang-Wei Lin | *National Changhua University of Education*

Huey-Por Chang | *Open University of Kaohsiung*

ICBASS-7479**A Study on the Traditional Carpenters in Chiayi City during the Japanese Colonial Period, Fujian**

Pei-Chi Su | *Southern Taiwan University of Science and Technology*

Ke-Hsuan Chu | *Southern Taiwan University of Science and Technology*

APTPC-114**Child Health Education of Teachers in a Day Care Center at Central Region of Thailand**

Somsiri Rungamornrat | *Mahidol University*

Apawan Nookong | *Mahidol University*

ISEPST-560**Promoting Educational Policy Model for the Aboriginal Children in Indonesia**

Suryawahyuni Latief | *National Dong Hwa University*

Wu-Hui Hua | *National Dong Hwa University*

Tu- Shao Wen | *National Dong Hwa University*

ICBASS-7450**Managers' Moral Development, Collectivism, and Unethical Pro-Organizational Behavior**

Yau-De Wang | *National Chiao Tung University*

ISEPST-536**Primal Landscape: Insights of University Students from Their Childhood's Outdoor Playing Environment**

Shuowen Tseng | *National Chiayi University*

ISEPST-558**TMS over Prefrontal Lobe Interrupts the Ability to Update Working Memory**

Yu-Ju Chou | *National Dong Hwa University*

Sin-Yi Wang | *National Dong Hwa University*

Meng-Ying Lee | *National Dong Hwa University*

ICBASS-7483**The Effects of Organizational Commitment and Cohesion on Organizational Citizenship Behavior- A Case Study of Home Delivery Company in Taiwan**

Tsung-Yu Chou | *National Chin-Yi University of Technology*

Chih-Min Chen | *National Chin-Yi University of Technology*

Chia-Chen Cheng | *National Chin-Yi University of Technology*

Kun-Hsien Li | *National Chin-Yi University of Technology*

ICBASS-7401**Cross-Border Transmission of Macroeconomic Conditions. The Case of Euro Area and Central and Eastern European Countries.**

Agata Wierzbowska | *Kobe University*

Poster Session (2)

Banking & Finance/ Communication & Society/

Marketing & Management/ Tourism

Room 1, 3F

2015/3/23 Monday 13:30-14:30

ICBASS-7438

The Impact of Industry Commonality on Post-Merger Performance

Hsuan-Chu Lin | *National Cheng Kung University*

Yi-Yun Chou | *National Cheng Kung University*

ICBASS-7349

Positive or Negative? The Influence of Message Framing, Regulatory Focus, and Product Type on Advertising Effects

Hsiao-Ching Lee | *National Kaohsiung University of Applied Sciences*

Ya-Chung Cheng | *National Kaohsiung University of Applied Sciences*

ICBASS-7524

Innovative Local Brand: A Case Study of Zeelandia Firm

Wei-Chen Yang | *Southern Taiwan University of Science and Technology*

Chia-Chun Lin | *Southern Taiwan University of Science and Technology*

Chao- Lun Lee | *Southern Taiwan University of Science and Technology*

Thomas Chiang Blair | *Southern Taiwan University of Science and Technology*

ICBASS-7317

The Capacity Allocation and Migration Planning Problem in the Semiconductor Packaging and Testing Industry

Yin-Yann Chen | *National Formosa University*

ICBASS-7432

Brand Image Communication through Multicultural

Thomas Chiang Blair | *Southern Taiwan University of Science and Technology*

Chia-Chun Lin | *Southern Taiwan University of Science and Technology*

Wei-Chen Yang | *Southern Taiwan University of Science and Technology*

ICBASS-7505**Effects of Fostering the Basic Competence of MICE Talents through Competition Learning: An Example of an Interdisciplinary Team Trained by the RD System**

Wei-Chen Yang | *Southern Taiwan University of Science and Technology*

Chia-Chun Lin | *Southern Taiwan University of Science and Technology*

Thomas Chiang Blair | *Southern Taiwan University of Science and Technology*

ICBASS-7512**Analyze Investment Strategy of the Life Insurance Industry Investing in Infrastructure**

Che Yang | *National Taipei University*

ISEPST-543**Using Importance–Performance Analysis to Explore the Environmental Properties of Bikeways**

Yen-Cheng Chiang | *National Chiayi University*

Yen-Ling Zhou | *National Chiayi University*

ISEPST-544**Traceability of Organic Food Products: A General Framework of Consumer Acceptance Model**

Chien-Yu Kuo | *National Kaohsiung University of Hospitality And Tourism*

Jun-Zhi Chiu | *National Kaohsiung University of Hospitality And Tourism*

Joyce Chen | *National Kaohsiung University of Hospitality And Tourism*

ISEPST-578**Festival and Travel Planning Network**

I. M. Hwang | *Chihlee Institute of Technology*

Wen-Hsuan Lien | *Chihlee Institute of Technology*

Ya-Wen Lu | *Chihlee Institute of Technology*

Yi-Jyun Chen | *Chihlee Institute of Technology*

Chih-Ching Chen | *Chihlee Institute of Technology*

ISEPST-579**The Relationship between Service Quality, and Loyalty: An Example of Taiwan Janfusun Fancy World**

Yu-Cheng Li | *National Yunlin University of Science and Technology*

Chih-Chiang Chung | *National Yunlin University of Science and Technology*

ISEPST-582**A Study of Relationships among Exhibition Service Quality and Behavioral Intention**

Yu-Tang Cheng | *National Yunlin University of Science and Technology*

Chih-Chiang Chung | *National Yunlin University of Science and Technology*

Poster Session (2)

Electrical Engineering and Technology

Room 1, 3F

2015/3/23 Monday 13:30-14:30

ACEAIT-3666

The Economic Dispatch of Cogeneration Systems in the Deregulation Market

Ming-Tang Tsai | *Cheng-Shiu University*

Guan-Zhi Wang | *Cheng-Shiu University*

Chi-Chun Lo | *Chang Jung Memorial Hospital*

Hung-Chi Chien | *Ming Chi University*

ACEAIT-3684

Design of a High Efficiency Single-Inductor Dual-Output Voltage Converter

Mei-Ling Yeh | *National Taiwan Ocean University*

Shih-Chi Chen | *National Taiwan Ocean University*

Po-Jen Cheng | *National Taiwan Ocean University*

Chung-Jui Shen | *National Taiwan Ocean University*

ACEAIT-3736

A Multi-Precision Floating-Point Dot Product Unit for Mobile Graphics Processing Units

Chih-Yuan Liang | *National Sun Yat-sen University*

Ming-Fong Chang | *National Sun Yat-sen University*

Yin-Chen Chang | *National Sun Yat-sen University*

Jhen-Fong Yang | *National Sun Yat-sen University*

Shiann-Rong Kuang | *National Sun Yat-sen University*

ACEAIT-3744

A Low-Cost BVH Construction Accelerator for Ray-Tracing

Yun-Nan Chang | *National Sun Yat-sen University*

ACEAIT-3749**A Coupled-Inductance Buck Converter with a ZVS Cell**

Cheng-Tao Tsai | *National Chin-Yi University of Technology*

Ang Lee | *National Chin-Yi University of Technology*

Ying-Che Kuo | *National Chin-Yi University of Technology*

Ying-Piao Kuo | *National Chin-Yi University of Technology*

Jye-Chau Su | *National Chin-Yi University of Technology*

ACEAIT-3752**Design of a Chaotic Synchronization Controller for Automobile Suspension System Based on Fuzzy Sliding Mode**

Neng-Sheng Pai | *National Chin-Yi University of Technology*

Hong-Yu You | *National Chin-Yi University of Technology*

Chin-Tsung Hsieh | *National Chin-Yi University of Technology*

Yung-Chang Luo | *National Chin-Yi University of Technology*

Jian-Min Chen | *National Chin-Yi University of Technology*

ACEAIT-3798**Least Square Support Vector Machine with Particle Swarm Optimization for Load Forecasting**

Whei-Min Lin | *National Sun Yat-sen University*

Chia-Sheng Tu | *National Sun Yat-sen University*

Ming-Tang Tsai | *Cheng-Shiu University*

Sheng-Cheng Fu | *Cheng-Shiu University*

ACEAIT-3812**Optimal Multi-Objective Train Speed Profile for Mass Transit Systems Using Genetic Algorithms**

Chaiyut Sumpavakup | *Suranaree University of Technology*

Thanatchai Kulworawanichpong | *Suranaree University of Technology*

ACEAIT-3821**Modeling and Simulation of Switching Transients in Electric Battery Bus Vehicle Charging Using MATLAB/SIMULINK**

Supachai Wongfukiat | *Suranaree University of Technology*

Thanatchai Kulworawanichpong | *Suranaree University of Technology*

ACEAIT-3822**Analysis of Energy Saving in Electric Battery Bus Vehicle Using On-Board Supercapacitors**

Wai-Ard Saikong | *Suranaree University of Technology*

Thanatchai Kulworawanichpong | *Suranaree University of Technology*

Warisara Panak | *Suranaree University of Technology*

ACEAIT-3826**A Study on Low-Complexity Embedded Convex Optimization Algorithms for FPGA Realization**

Hsin-Yu Chen | *Yuan Ze University*

Kuo-Min Huang | *Yuan Ze University*

Xiaoyan Chen | *Yuan Ze University*

Kan-Lin Hsiung | *Yuan Ze University*

Poster Session (3)

**Biomedical Engineering/ Biophysics/Civil Engineering/
Chemical Sciences/ Computer Engineering and Technology/
Information Engineering and Technology /
Materials Science and Engineering/
Mechanical Engineering and Technology
Room 1, 3F**

2015/3/23 Monday 15:00-16:00

ACEAIT-3695

Finite Element Analysis of Tibia Diaphyseal Fracture with Elastic Stable Intramedullary Nails

Yen-Nien Chen | *National Cheng Kung University*

Yao-Te Peng | *National Cheng Kung University*

Chih-Wei Wang | *National Cheng Kung University*

Chih-Hsien Chen | *National Cheng Kung University*

Chih-Han Chang | *National Cheng Kung University*

I-An Chen | *Metal Industries Research & Development Centre*

ACEAIT-3726

The Evaluation and Development of Posture Monitoring Device Using Flex Sensor

Yao-Te Peng | *National Cheng Kung University*

Yen-Nien Chen | *National Cheng Kung University*

Wei-Hsun Huang | *National Cheng Kung University*

Chih-Han Chang | *National Cheng Kung University*

ACEAIT-3734

Noninvasive Measurement of Body Temperature Distribution in Radio-Frequency Hyperthermia Treatment

Ki Sun Park | *Kookmin University*

Jung Kyung Kim | *Kookmin University*

Hee Joon Lee | *Kookmin University*

ACEAIT-3803**Experimental and Analytical Study on the Dynamic Behavior of Frames under Relative Displacement between Support Points**

Tomohiro Nakano | *Tokai University*

ACEAIT-3760**Based on Openmp Parallel Technology Designs Motion Estimation Algorithms of H.264/AVC Video Coding Standard**

Hung-Ming Chen | *National Taichung University of Science and Technology*

Ching-Chieh Ho | *National Taichung University of Science and Technology*

ACEAIT-3680**A Routing Strategy for Vehicular ad hoc Networks based on Geographic Internet Protocol**

Min-Xiou Chen | *National Dong Hwa University Taiwan*

ACEAIT-3730**Weighted Multicategory Support Vector Machine for Unbalanced Cases**

Kang-Mo Jung | *Kunsan National University*

ACEAIT-3765**A Directory -Aware Rebalancer's Algorithm for Solving Data Skew in HDFS**

Hsiang Jen Hsiao | *National Chung Hsing University*

Juh Shang Kao | *National Chung Hsing University*

ACEAIT-3824**A Low-Complex Digital Demodulator for Low-Rate Chirp Spread-Spectrum Communications**

Yih-Min Chen | *National Central University*

ACEAIT-3709**Pt-free Dye-Sensitized Solar Cells Based on Counter Electrodes of Graphene/ TaS₂ Composite Material**

Yu-Chen Chou | *Huafan University*

Chien-Chin Wang | *Huafan University*

Huai-Yi Chen | *Huafan University*

ACEAIT-3655

Development of a Rapid Tooling Using Recycled Al-Filled Epoxy Resin Powders and Epoxy Resins

Chil-Chyuan Kuo | *Ming Chi University of Technology*

Shin-Yun Lyu | *Ming Chi University of Technology*

ISFAS-1206

D-galactan II is an Immunodominant Antigen in O1 Lipopolysaccharide and Affects Virulence in *Klebsiella Pneumoniae*: Implication in Vaccine Design

Pei-Fang Hsieh | *National Taiwan University College of Medicine*

Chun-Tang Chen | *National Taiwan University College of Medicine*

Yi-Yin Chen | *National Taiwan University College of Medicine*

Jin-Town Wang | *National Taiwan University College of Medicine*

Meng-Chuan Wu | *National Taiwan University Hospital*

Jin-Chuan Sheu | *National Taiwan University Hospital*

Feng-Ling Yang | *Academia Sinica*

Tzu-Chi Lou | *Academia Sinica*

Shih-Hsiung Wu | *Academia Sinica*

ISFAS-1195

Raman and Photoluminescence Investigation of CdS/CdSe Quantum Dots on TiO₂ Nanoparticles with Multi-Walled Carbon Nanotubes and Their Application in Solar Cells

Kun-Mu Lee | *National Central University*

Sheng Hsiung Chang | *National Central University*

Chun-Guey Wu | *National Central University*

ISFAS-1300

Effects of Electroplating Additives on the Sn/Cu Interfacial Reactions

Hsuan Lee | *National Chung Hsing University*

Je-Yi Wu | *National Chung Hsing University*

Chih-Ming Chen | *National Chung Hsing University*

ISFAS-1193

Phase Equilibria of the Sn-Fe-Ni Ternary System at 2700C

Yee-Wen Yen | *National Taiwan University of Science and Technology*

Hung-Lun Liu | *National Taiwan University of Science and Technology*

Shih-Wei Lin | *National Taiwan University of Science and Technology*

Tzu-Ting Huang | *National Taiwan University of Science and Technology*

ISFAS-1239**Preparation and Properties of Nitrogen Doped Cuprous Oxide Thin Films**

Yung-Hui Shih | *I-Shou University*

Guo-Ju Chen | *I-Shou University*

Wei-Ting Liang | *I-Shou University*

Hue-Mei Lee | *I-Shou University*

ISFAS-1252**Comparing of Corrosion Behavior of a Zr-Based Bulk Metallic Glass and a Zr-Based Bulk Metallic Glass Composite in a Sodium Chloride Aqueous Solution**

Huei-Sen Wang | *I-Shou University*

Wei-Hau Li | *I-Shou University*

Mei-Hui Wu | *China Steel Corporation*

Jason Shian-Ching Jang | *National Central University*

ISFAS-1254**Tribological Behaviors of CNT/Silica and CNT/Alumina Composites Fabricated by Catalyst Sol-Gel and CVD Process**

Kuo-Jung Lee | *I-Shou University*

Yu-Ting Yeh | *I-Shou University*

Huy-Zu Cheng | *I-Shou University*

ISFAS-1255**Preparation of $\text{SrSi}_2\text{O}_7\text{N}_2\text{:Eu}^{2+}$ Phosphors by Direct Silicon Nitridation**

Jyung-Dong Lin | *I-Shou University*

Yen-Chang Liu | *I-Shou University*

ISFAS-1257**Maskless Lateral Epitaxial Overgrowth of High Quality ZnO Films through the Assistance of Stripe-Patterned ZnAl_2O_4 Buffer Layer**

Hou-Guang Chen | *I-Shou University*

Ming-Yang Yu | *I-Shou University*

Xuan-Chen Lin | *I-Shou University*

ISFAS-1299

Biomechanical Evaluation of Small Diameter of One- and Two-Pieces Dental Implants

Aaron Yu-Jen Wu | *Chang Gung University*

Winston Chee | *University of Southern California*

Jui-Ting Hsu | *China Medical University*

Yun-Te Lin | *China Medical University*

Heng-Li Huang | *China Medical University*

Poster Session (4)

Food, Agriculture and Veterinary Sciences/

Geology, Earth and Environmental Sciences/

Green Technology/ Nanotechnology/ Physics Sciences

Room 1, 3F

2015/3/23 Monday 16:30-17:30

ISFAS-1250

Effect of Ultrasonic Treatment on Properties and Antioxidant Capacity of Purple Corn Cob

Teerarat Itthisoponkul | *Srinakharinwirot University*

Siripatsorn Prompun | *Srinakharinwirot University*

ISFAS-1327

Neurobehaviral Effects of Ficus Deltoidea and Vitexin on Streptozotocin Induced Diabetic Rats

Nurdiana Samsulrizal | *Universiti Teknologi MARA*

Goh Yong Meng | *Universiti Teknologi MARA*

Hafandi Ahmad | *Universiti Teknologi MARA*

Nur Syimalain Azmi | *Universiti Teknologi MARA*

Razin Azizan Razali | *Universiti Teknologi MARA*

Noor Syaffinaz | *Universiti Teknologi MARA*

Siti Khairiyah | *Universiti Teknologi MARA*

ISFAS-1333

Application of Alternating Current Atmospheric Pressure Plasma to Brown Rice Modification

Hua Han Chen | *National Penghu University of Science and Technology*

Jia Ru Lin | *National Penghu University of Science and Technology*

Yi Ting Shen | *National Penghu University of Science and Technology*

Su Yi Lin | *Chinese Culture University*

ISFAS-1210**Prediction of Critical Depth Considering Rainfall Intensity in the Landslide**

Min-Gyu Kim | *Andong National University*

Jeong-Ok Ryu | *Andong National University*

Jea-Hyoung Lee | *Andong National University*

Gyo-Cheol Jeong | *Andong National University*

Jong-Tae Kim | *Korea Institute of Construction Technology*

ISFAS-1231**Electrospun Nanoporous Fibers Based on Graphene/Polyaniline/Polystyrene Modified Electrode for Simultaneous Determination of Lead and Cadmium**

Nadtinan Promphet | *Chulalongkorn University*

Ratthapol Rangkupan | *Chulalongkorn University*

Nadnudda Rodthongkum | *Chulalongkorn University*

Poomrat Rattanasat | *Chulalongkorn University*

Orawon Chailapakul | *Chulalongkorn University*

ISFAS-1293**Potential for Synthesis of Chelating Fibers and Sorption of Aqueous Heavy Metals**

Patcharin Racho | *Suranaree University of Technology*

Pinita Phalathip | *Suranaree University of Technology*

ISFAS-1298**An Ultrasonic Physical Model Study of Seismic Image in a Tilted Transversely Isotropic Medium**

Chih-Hsiung Chang | *National Chiayi University*

Young-Fo Chang | *National Chung Cheng University*

Cheng-Wei Tseng | *National Chung Cheng University*

ISFAS-1308**Geophysical Investigations for Delineation of Potential GroundWater Zones in Jizan Area, Southern Red Sea Coast, Saudi Arabia**

Saad Mogren Almogren | *King Saud University*

ISFAS-1274**Renewable Energy from the Water Supply of Sanitary Ware for Small Electrical Generates**

Sayrung Panthong | *King Mongkut's Institute of Technology Ladkrabang*

Keerayoot Srinuanjan | *King Mongkut's Institute of Technology Ladkrabang*

Thammarat Taengtang | *King Mongkut's Institute of Technology Ladkrabang*

Sarai Lekchaum | *King Mongkut's Institute of Technology Ladkrabang*

ISFAS-1230**A Novel Electrochemical Biosensor Based on Graphene/Polyaniline Nanocomposite Modified Electrode**

Jutiporn Yukird | *Chulalongkorn University*

Ratthapol Rangkupan | *Chulalongkorn University*

Nadnudda Rodthongkum | *Chulalongkorn University*

Trairak Pisitkun | *Chulalongkorn University*

Orawon Chailapakul | *Chulalongkorn University*

ISFAS-1280**Highly Efficient Photoelectrochemical Hydrogen Generation Using a Pt-MoS₂/Si Nanowire Array**

Hsin Hua Chen | *National Yunlin University of Science and Technology*

Sheng Ta Ho | *National Yunlin University of Science and Technology*

Wen Jauh Chen | *National Yunlin University of Science and Technology*

Shu-Huei Hsieh | *National Formosa University*

ISFAS-1228**Electrical Parameters and Conduction Mechanisms in CdS/CuO Thin Film Heterojunction**

Thitinai Gaewdang | *King Mongkut's Institute of Technology Ladkrabang*

Ngamnit Wongcharoen | *King Mongkut's Institute of Technology Ladkrabang*

ISFAS-1229**Preparation and Characterization of Copper Oxide Thin Films Prepared by Oxidation of Thermally Evaporated Cu Thin Films**

Ngamnit Wongcharoen | *King Mongkut's Institute of Technology Ladkrabang*

Thitinai Gaewdang | *King Mongkut's Institute of Technology Ladkrabang*

ISFAS-1269**The Analytical Model of Bending Bragg Gratings in Poly (Methyl Methacrylate) for Strain Sensing Application**

Niparat Cheamanunkul | *King Mongkut's Institute of Technology Ladkrabang*

Keerayoot Srinuanjan | *King Mongkut's Institute of Technology Ladkrabang*

Sarai Lekchaum | *King Mongkut's Institute of Technology Ladkrabang*

Preecha P Yupapin | *King Mongkut's Institute of Technology Ladkrabang*

ISFAS-1335**Development of Protein-Based Biosensors and Protein-Nanofiber-Based Nanosensors for in Vitro Drug Screening, Heavy Metal Detection and Bacterial Beta-Lactamase Sensing**

Lan Zou | *The Hong Kong Polytechnic University*

Wing-Lam Cheong | *The Hong Kong Polytechnic University*

Wai-Hong Leung | *The Hong Kong Polytechnic University*

Pak-Ho Chan | *The Hong Kong Polytechnic University*

The Hong Kong Polytechnic University Shenzhen Research Institute

ISFAS-1337**Transmission Model of Dengue Disease with the Effect of Raining in Thailand**

Puntani Pongsumpun | *King Mongkut's Institute of Technology Ladkrabang*

